

Linear Electric Actuator

Series AVRS

Cat :

Rod Type Ball Screw Actuator - Heavy Series - 40mm

Features

- Compact Robust Design
- Highly flexible mounting
- More Precise & positioning
- Ease of positioning
- Ease of Maintenance



Technical Specifications

Repeatability (mm)		±0.02									
Motor Power (W)		200W				400W					
Motor Speed (RPM)		3000				3000					
Rated Torque (N.m)		0.64				1.27					
Ball Screw Lead (mm)		5		10				5		10	
Maximum Speed (mm/s)*		250	125	500	250	167	125	250	500	250	
Rated Thrust(N)		683	1366	342	684	1026	1386	1360	680	1360	
Gear Ratio		1:1	2:1	1:1	2:1	3:1	4:1	1:1	1:1	2:1	
Stroke (mm)		50-600mm									
Ball screw Ø (mm)		C7 Ø 10									
Home Sensor	Outside	AM42 Reed Switch									

*Acceleration and deceleration value is set 0.2sec

Front End Connection:

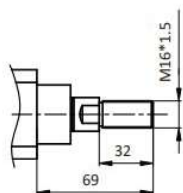

Male

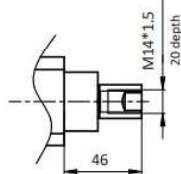

Female

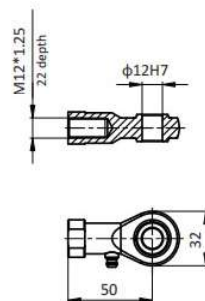

Rod end Spherical eye

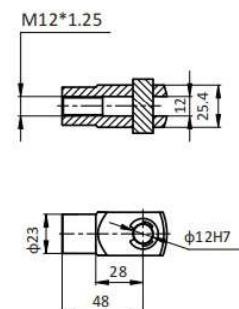

Rod end Fork

Linear Electric Actuator

Series AVRS

Cat :

Direct Front Installation:

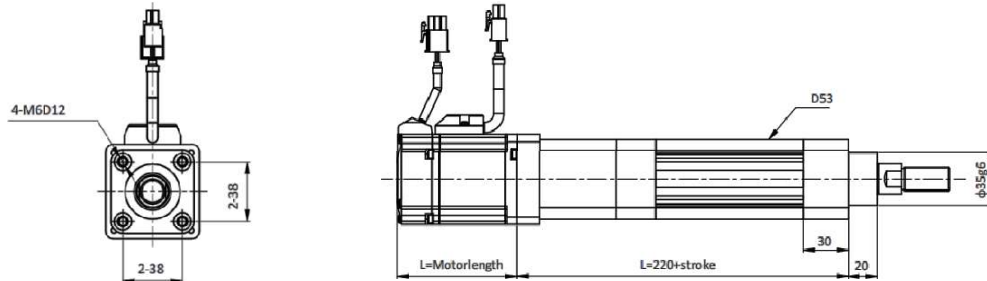

Stroke(mm)	50	100	150	200	250	300	350	400	450	500	550	600
Weight(Kg)	2.62	2.87	3.12	3.37	3.62	3.87	4.12	4.37	4.62	4.87	5.12	5.37

Direct Front Flange Installation :

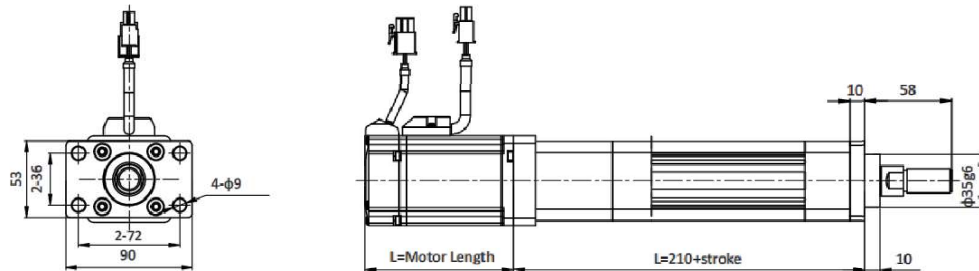

Stroke(mm)	50	100	150	200	250	300	350	400	450	500	550	600
Weight(Kg)	2.59	2.84	3.09	3.34	3.59	3.84	4.09	4.34	4.59	4.84	5.09	5.34

Direct Rear Flange Installation :

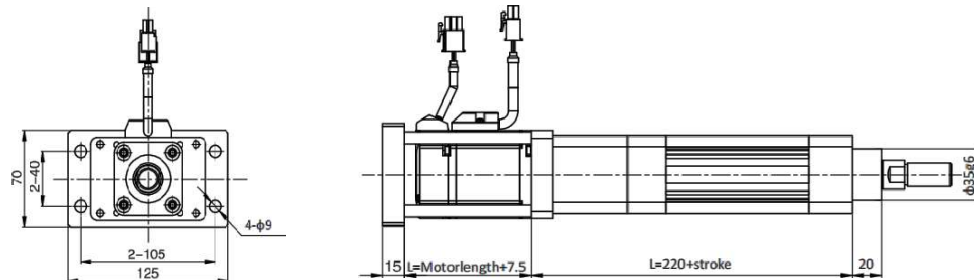

Stroke(mm)	50	100	150	200	250	300	350	400	450	500	550	600
Weight(Kg)	3.17	3.42	3.67	3.92	4.17	4.42	4.67	4.92	5.17	5.42	5.67	5.94

Linear Electric Actuator

Series AVRS

Cat :

Direct Trunnion Installation:

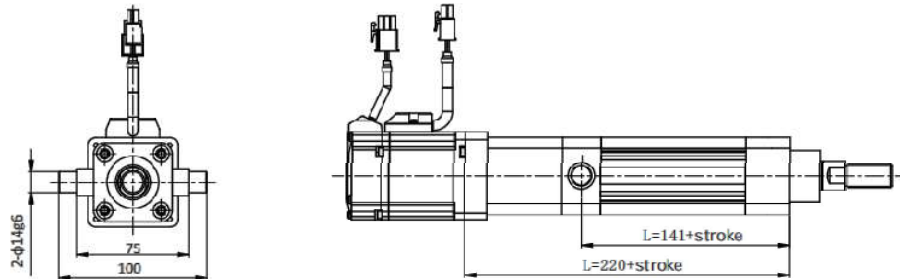

Stroke(mm)	50	100	150	200	250	300	350	400	450	500	550	600
Weight(Kg)	2.65	2.9	3.15	3.4	3.65	3.9	4.15	4.4	4.65	4.9	5.15	5.4

Direct Side Installation:

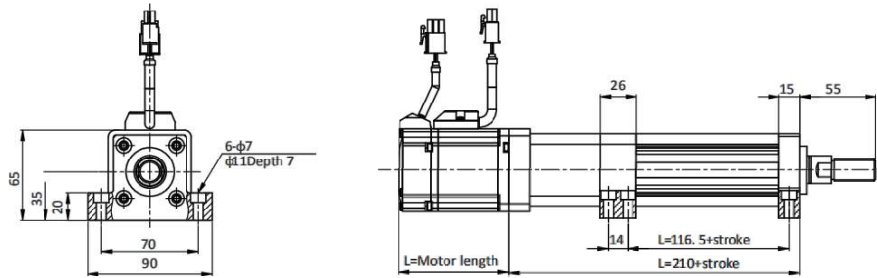

Stroke(mm)	50	100	150	200	250	300	350	400	450	500	550	600
Weight(Kg)	2.63	2.88	3.13	3.38	3.63	3.88	4.13	4.38	4.63	4.88	5.13	5.38

Direct Front Guide Installation:

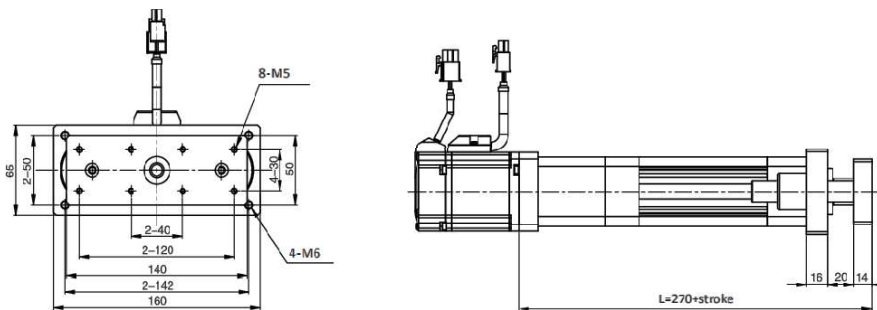

Stroke(mm)	50	100	150	200	250	300	350	400	450	500	550	600
Weight(Kg)	3.84	4.24	4.64	5.04	5.44	5.84	6.24	6.64	7.04	7.44	7.84	8.24

Linear Electric Actuator

Series AVRS

Cat :

Direct Male Clevis Installation:

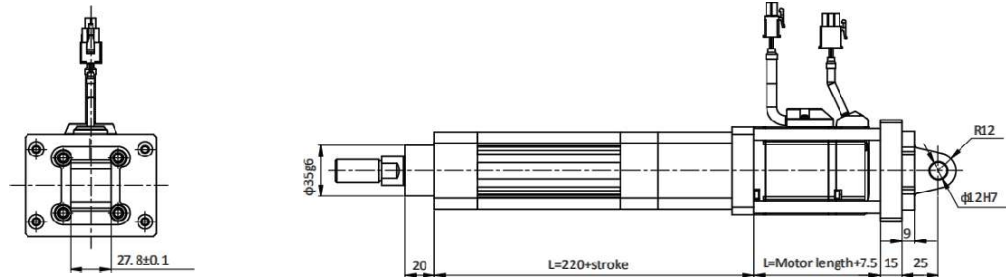

Stroke(mm)	50	100	150	200	250	300	350	400	450	500	550	600
Weight(Kg)	3.29	3.54	3.79	4.04	4.29	4.54	4.79	5.04	5.29	5.54	5.79	6.04

Direct Female Clevis Installation:

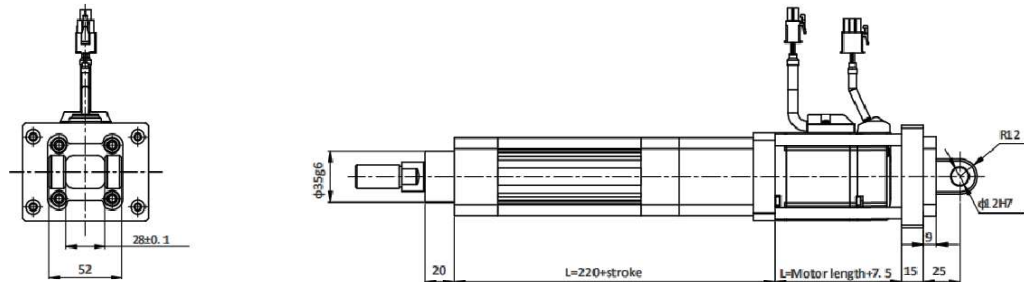

Stroke(mm)	50	100	150	200	250	300	350	400	450	500	550	600
Weight(Kg)	3.26	3.51	3.76	4.01	4.26	4.51	4.76	5.01	5.26	5.51	5.76	6.01

Transition Front Installation:

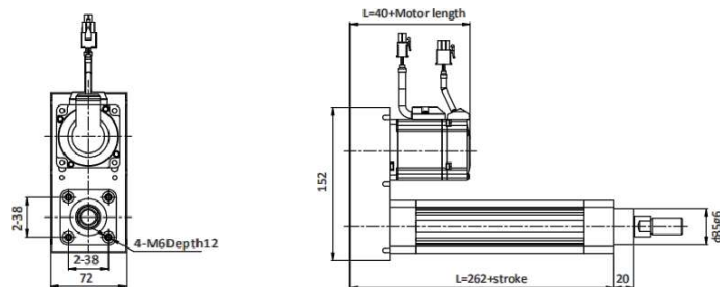

Stroke(mm)	50	100	150	200	250	300	350	400	450	500	550	600
Weight(Kg)	2.74	2.99	3.24	3.49	3.74	3.99	4.24	4.49	4.74	4.99	5.24	5.49

Linear Electric Actuator

Series AVRS

Cat :

Transition Front Flange Installation:

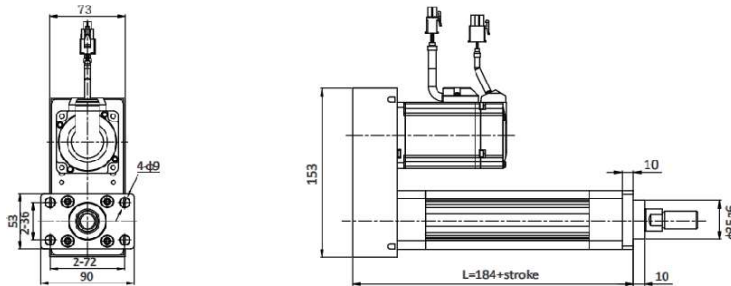

Stroke(mm)	50	100	150	200	250	300	350	400	450	500	550	600
Weight(Kg)	3.05	3.3	3.55	3.8	4.05	4.3	4.55	4.8	5.05	5.3	5.55	5.8

Transition Rear Flange Installation:

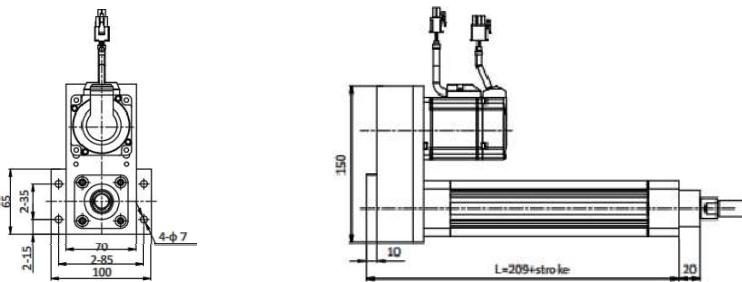

Stroke(mm)	50	100	150	200	250	300	350	400	450	500	550	600
Weight(Kg)	3.05	3.3	3.55	3.8	4.05	4.3	4.55	4.8	5.05	5.3	5.55	5.8

Transition Trunnion Installation:

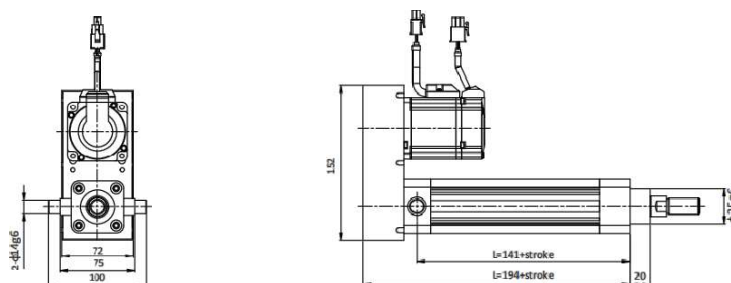

Stroke(mm)	50	100	150	200	250	300	350	400	450	500	550	600
Weight(Kg)	2.77	3.02	3.27	3.52	3.77	4.02	4.27	4.52	4.77	5.02	5.27	5.52

Linear Electric Actuator

Series AVRS

Cat :

Transition Side Installation:

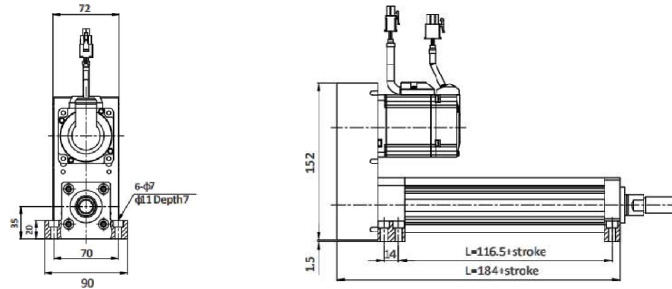

Stroke(mm)	50	100	150	200	250	300	350	400	450	500	550	600
Weight(Kg)	2.75	3	3.25	3.5	3.75	4	4.25	4.5	4.75	5	5.25	5.5

Transition Front Guide Installation:

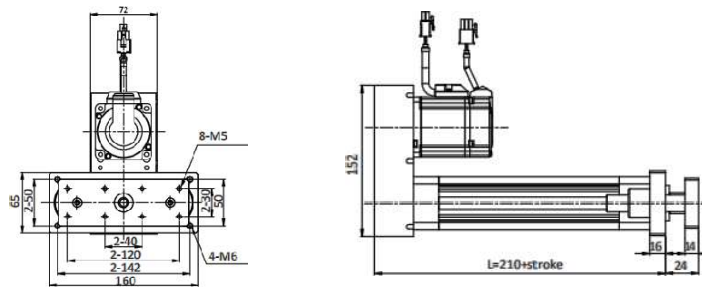

Stroke(mm)	50	100	150	200	250	300	350	400	450	500	550	600
Weight(Kg)	3.96	4.36	4.76	5.16	5.56	5.96	6.36	6.76	7.16	7.56	7.96	8.36

Transition Male Clevis Installation:

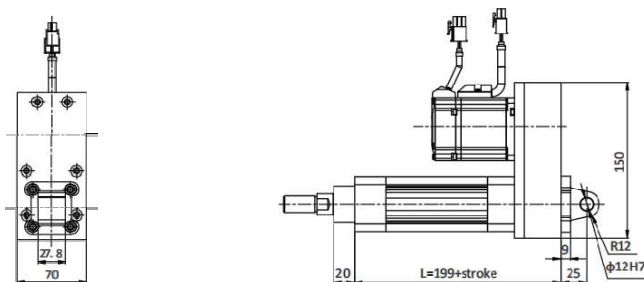

Stroke(mm)	50	100	150	200	250	300	350	400	450	500	550	600
Weight(Kg)	3.2	3.45	3.7	3.95	4.2	4.45	4.7	4.95	5.2	5.45	5.7	5.95

Linear Electric Actuator

Series AVRS

Cat :

How to order

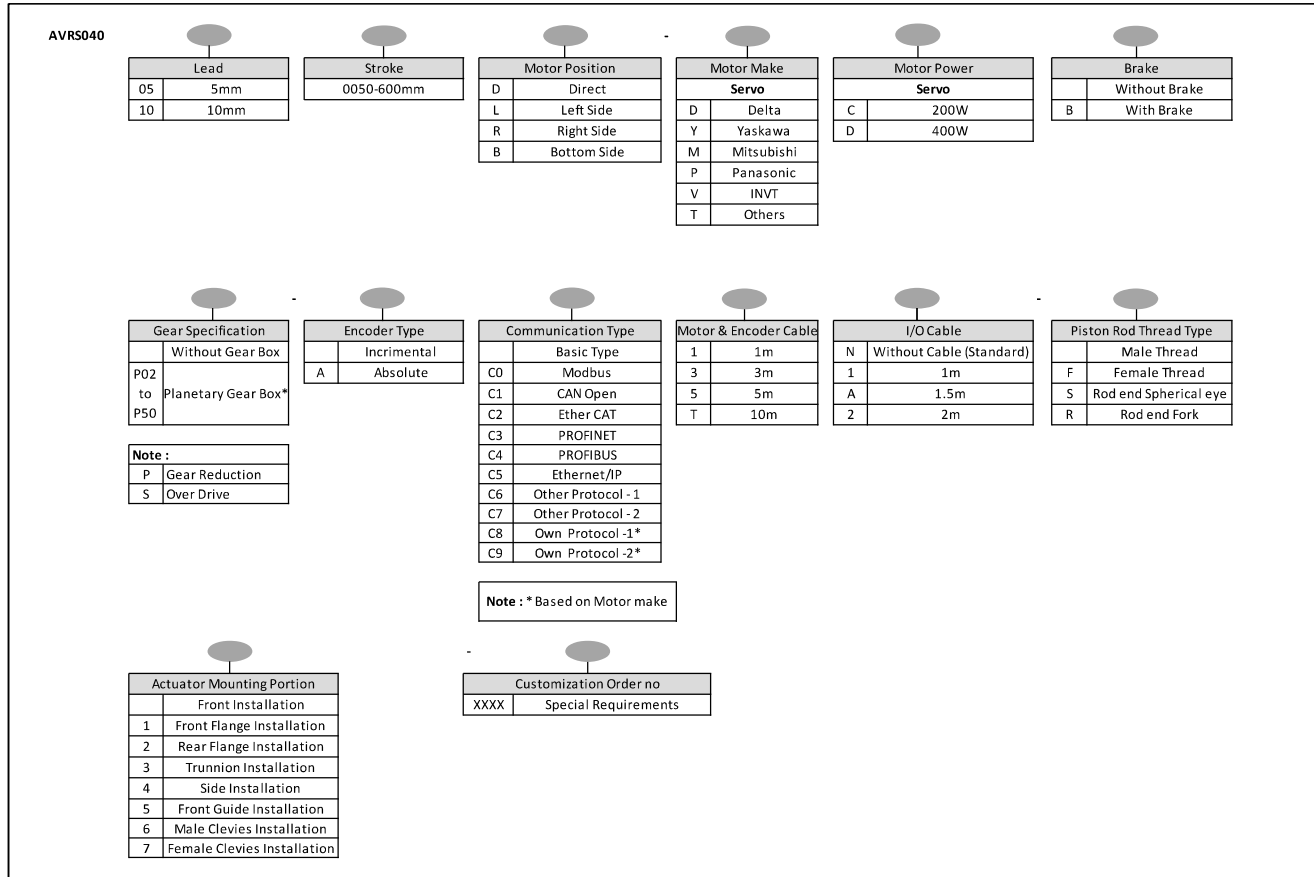

Example:1

Order no. for Rod type ball screw electric actuator VDMA 40mm size, 10mm Lead, 500mm stroke with Delta 400W servo motor mounted at the motor Direct, with 3m Motor & Encoder cable.

AVRS040100500D-DD-3N

Example:2

Order no. for Rod type ball screw electric actuator VDMA 40mm size, 10mm Lead, 500mm stroke without Delta 400W servo motor mounted at the motor Direct.

AVRS040100500D-DD

Linear Electric Actuator

Series AVRS

Cat :

Rod Type Ball Screw Actuator - Heavy Series - 50mm

Features

- Compact Robust Design
- Highly flexible mounting
- More Precise & positioning
- Ease of positioning
- Ease of Maintenance



Technical Specifications

Repeatability (mm)	±0.02										
Motor Power (W)	400W					750W		1000W	1000W		
Rated Torque (N.m)	1.27					2.4		3.18	4.77		
Motor Speed (RPM)	3000					3000		3000	2000		
Ball Screw Lead (mm)	5		10				5	10		10	10
Maximum Speed (mm/s)*	250	125	500	250	167	125	250	500	250	500	333
Rated Thrust (N)	1360	2720	680	1360	2040	2720	2562	1281	2562	1697	2546
Gear Ratio	1:1	2:1	1:1	2:1	3:1	4:1	1:1	1:1	2:1	1:1	1:1
Stroke (mm)	50-1000mm										
Ball Screw Diameter (mm)	C7 Ø 16										
Home Sensor	Outside	AM42 Reed Switch									

*Acceleration and deceleration value is set 0.2sec

Front End Connection:

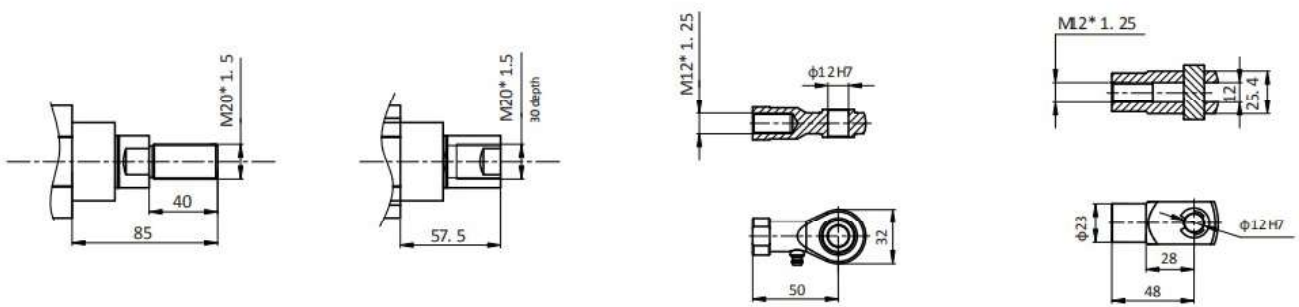

Male

Female

Rod end Spherical eye

Rod end Fork

Linear Electric Actuator

Series AVRS

Cat :

Direct Front Installation:

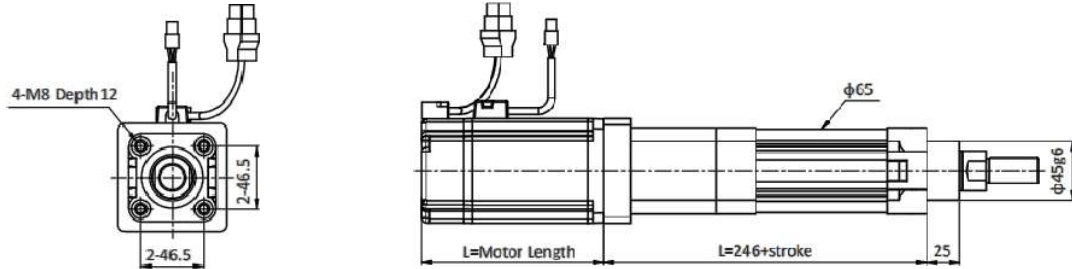

Stroke(mm)	50	100	150	200	250	300	350	400	450	500
Weight(Kg)	4.07	4.57	5.07	5.57	6.07	6.57	7.07	7.57	8.07	8.57
Stroke(mm)	550	600	650	700	750	800	850	900	950	1000
Weight(Kg)	9.07	9.57	10.07	10.57	11.07	11.57	12.07	12.57	13.07	13.57

Direct Front Flange Installation:

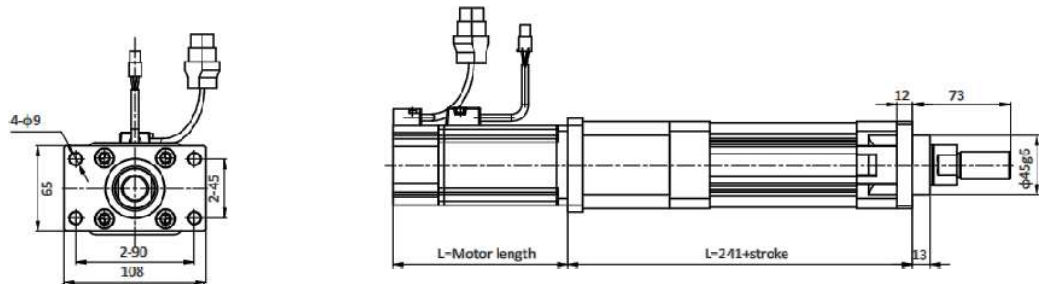

Stroke(mm)	50	100	150	200	250	300	350	400	450	500
Weight(Kg)	3.95	4.45	4.95	5.45	5.95	6.45	6.95	7.45	7.95	8.45
Stroke(mm)	550	600	650	700	750	800	850	900	950	1000
Weight(Kg)	8.95	9.45	9.95	10.45	10.95	11.45	11.95	12.45	12.95	13.45

Direct Rear Flange Installation:

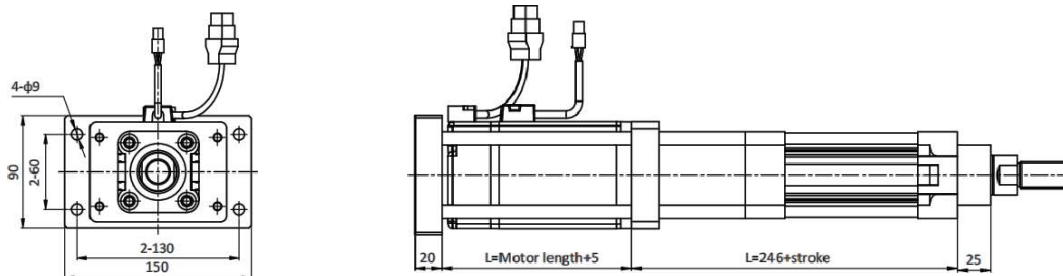

Stroke(mm)	50	100	150	200	250	300	350	400	450	500
Weight(Kg)	5.15	5.65	6.15	6.65	7.15	7.65	8.15	8.65	9.15	9.65
Stroke(mm)	550	600	650	700	750	800	850	900	950	1000
Weight(Kg)	10.15	10.65	11.15	11.65	12.15	12.65	13.15	13.65	14.15	14.65

Linear Electric Actuator

Series AVRS

Cat :

Direct Trunnion Installation:

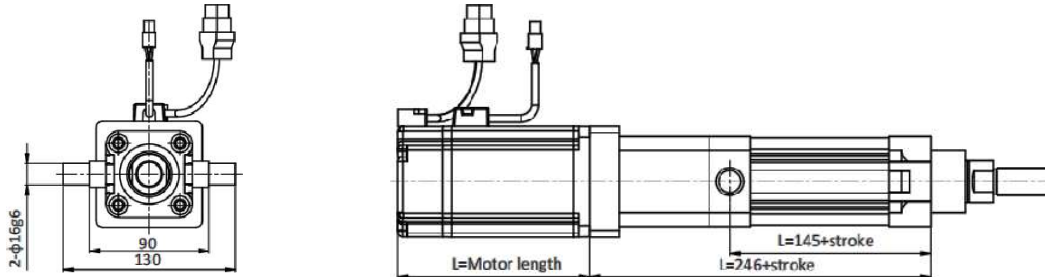

Stroke(mm)	50	100	150	200	250	300	350	400	450	500
Weight(Kg)	4.11	4.61	5.11	5.61	6.1	6.61	7.11	7.61	8.11	8.61
Stroke(mm)	550	600	650	700	750	800	850	900	950	1000
Weight(Kg)	9.11	9.61	10.11	10.61	11.11	11.61	12.11	12.61	13.11	13.61

Direct Side Installation:

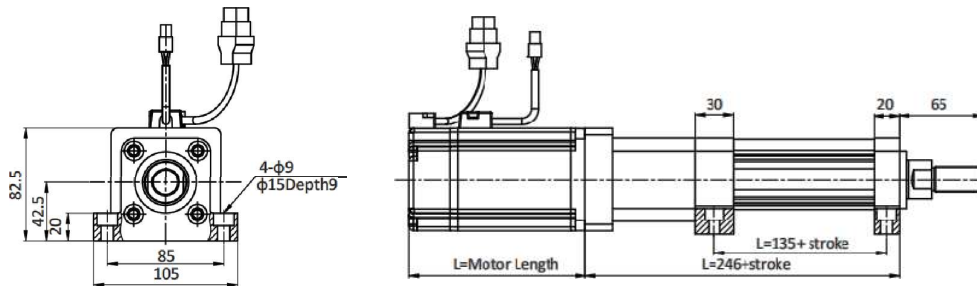

Stroke(mm)	50	100	150	200	250	300	350	400	450	500
Weight(Kg)	4.15	4.65	5.15	5.65	6.15	6.65	7.15	7.65	8.15	8.65
Stroke(mm)	550	600	650	700	750	800	850	900	950	1000
Weight(Kg)	9.15	9.65	10.15	10.65	11.15	11.65	12.15	12.65	13.11	13.65

Direct Front Guide Installation:

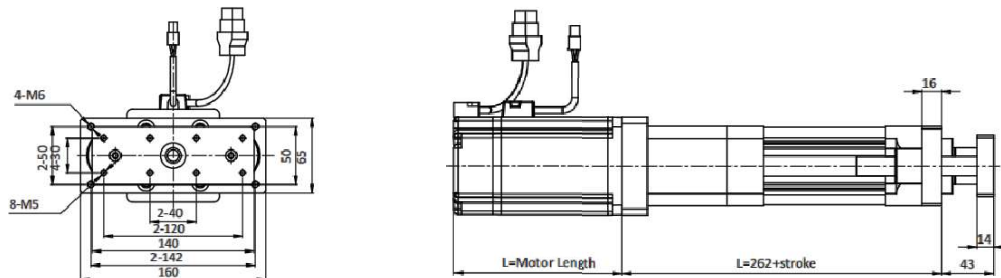

Stroke(mm)	50	100	150	200	250	300	350	400	450	500
Weight(Kg)	5.2	5.75	6.3	6.85	7.4	7.95	8.5	9.05	9.6	10.15
Stroke(mm)	550	600	650	700	750	800	850	900	950	1000
Weight(Kg)	10.7	11.25	11.8	12.35	12.9	13.45	14	14.55	15.1	15.65

Linear Electric Actuator

Series AVRS

Cat :

Direct Male Clevis Installation:

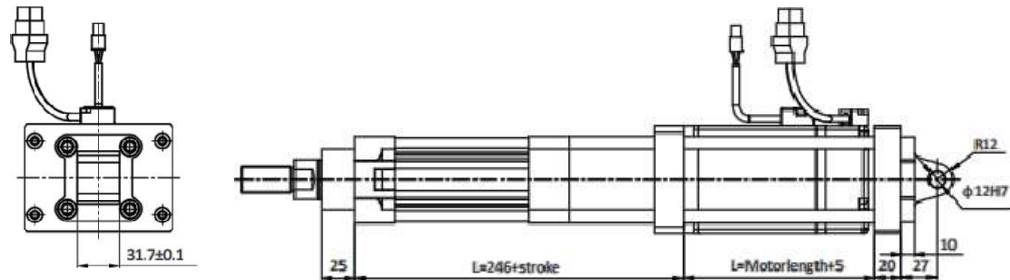

Stroke(mm)	50	100	150	200	250	300	350	400	450	500
Weight(Kg)	5.77	6.27	6.77	7.27	7.77	8.27	8.77	9.27	9.77	10.27
Stroke(mm)	550	600	650	700	750	800	850	900	950	1000
Weight(Kg)	10.77	11.27	11.77	12.27	12.77	13.27	13.77	14.27	14.77	15.27

Direct Female Clevis Installation:

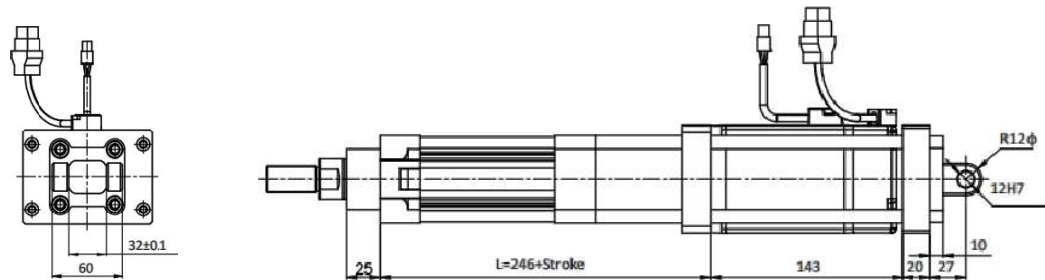

Stroke(mm)	50	100	150	200	250	300	350	400	450	500
Weight(Kg)	5.73	6.23	6.73	7.23	7.73	8.23	8.73	9.23	9.73	10.23
Stroke(mm)	550	600	650	700	750	800	850	900	950	1000
Weight(Kg)	10.73	11.23	11.73	12.23	12.73	13.23	13.73	14.23	14.73	15.23

Transition Front Installation:

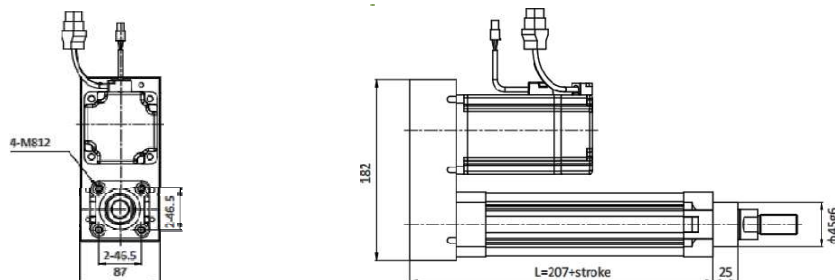

Stroke(mm)	50	100	150	200	250	300	350	400	450	500
Weight(Kg)	4.37	4.87	5.37	5.87	6.37	6.87	7.37	7.87	8.37	8.87
Stroke(mm)	550	600	650	700	750	800	850	900	950	1000
Weight(Kg)	9.37	9.87	10.37	10.87	11.37	11.87	12.37	12.87	13.37	13.87

Linear Electric Actuator

Series AVRS

Cat :

Transition Front Flange Installation:

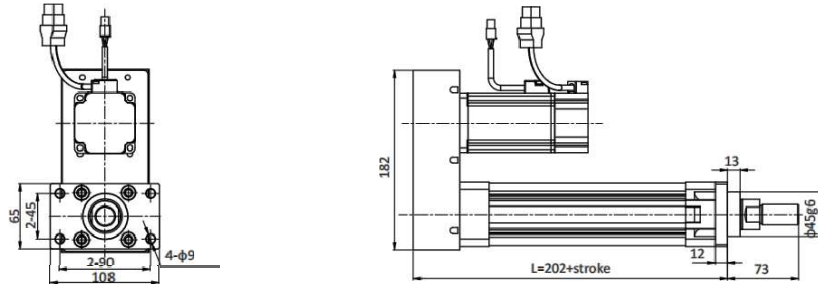

Stroke(mm)	50	100	150	200	250	300	350	400	450	500
Weight(Kg)	4.25	4.75	5.25	5.75	6.25	6.75	7.25	7.75	8.25	8.75
Stroke(mm)	550	600	650	700	750	800	850	900	950	1000
Weight(Kg)	9.25	9.75	10.25	10.75	11.25	11.75	12.25	12.75	13.25	13.75

Transition Rear Flange Installation:

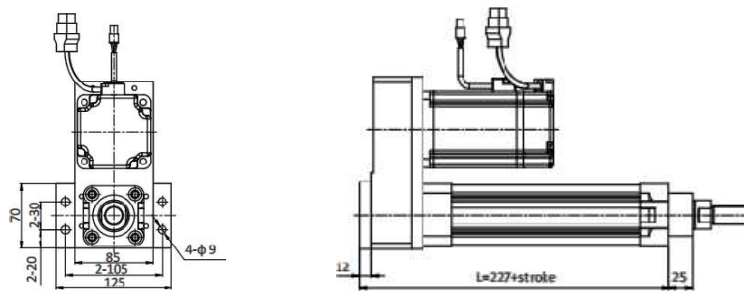

Stroke(mm)	50	100	150	200	250	300	350	400	450	500
Weight(Kg)	5.04	5.54	6.04	6.54	7.04	7.54	8.04	8.54	9.04	9.54
Stroke(mm)	550	600	650	700	750	800	850	900	950	1000
Weight(Kg)	10.04	10.54	11.04	11.54	12.04	12.54	13.04	13.54	14.04	14.54

Transition Trunnion Installation:

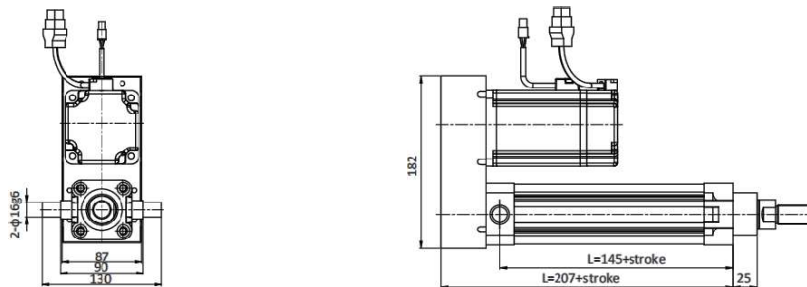

Stroke(mm)	50	100	150	200	250	300	350	400	450	500
Weight(Kg)	4.41	4.91	5.41	5.91	6.41	6.91	7.41	7.91	8.41	8.91
Stroke(mm)	550	600	650	700	750	800	850	900	950	1000
Weight(Kg)	9.41	9.91	10.41	10.91	11.41	11.91	12.41	12.91	13.41	13.91

Linear Electric Actuator

Series AVRS

Cat :

Transition Side Installation :

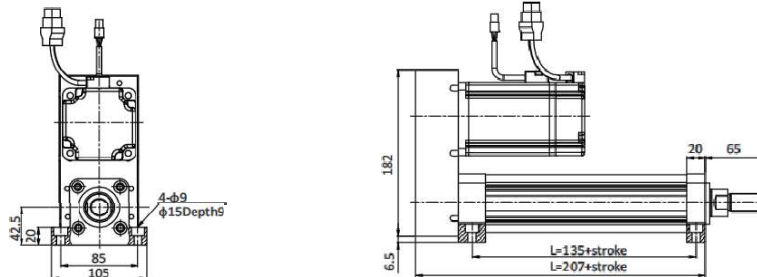

Stroke(mm)	50	100	150	200	250	300	350	400	450	500
Weight(kg)	4.45	4.95	5.45	5.95	6.45	6.95	7.45	7.95	8.45	8.95
Stroke(mm)	550	600	650	700	750	800	850	900	950	1000
Weight(kg)	9.45	9.95	10.45	10.95	11.45	11.95	12.45	12.95	13.45	13.95

Transition Front Guide Installation:

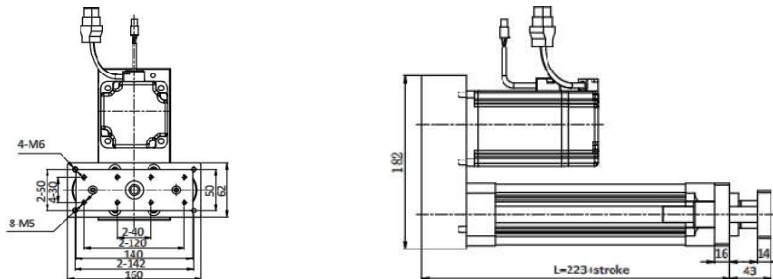

Stroke(mm)	50	100	150	200	250	300	350	400	450	500
Weight(kg)	5.5	6.05	6.6	7.15	7.7	8.25	8.8	9.35	9.9	10.45
Stroke(mm)	550	600	650	700	750	800	850	900	950	1000
Weight(kg)	11	11.55	12.1	12.65	13.2	13.75	14.3	14.85	15.4	15.95

Transition Male Clevis Installation:

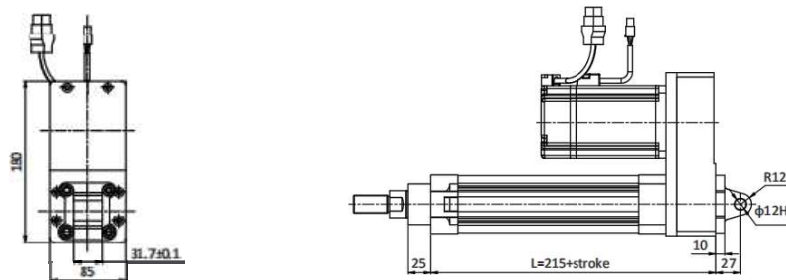

Stroke(mm)	50	100	150	200	250	300	350	400	450	500
Weight(Kg)	5.37	5.87	6.37	6.87	7.37	7.87	8.37	8.87	9.37	9.87
Stroke(mm)	550	600	650	700	750	800	850	900	950	1000
Weight(Kg)	10.37	10.87	11.37	11.87	12.37	12.87	13.37	13.87	14.37	14.87

Linear Electric Actuator

Series AVRS

Cat :

Transition Female Clevis Installation:

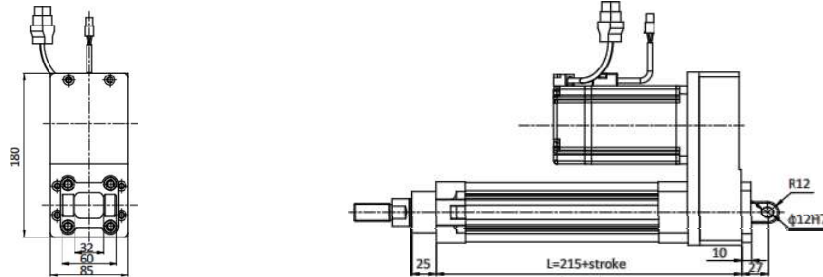

Stroke(mm)	50	100	150	200	250	300	350	400	450	500
Weight(kg)	5.33	5.83	6.33	6.83	7.33	7.83	8.33	8.83	9.33	9.83
Stroke(mm)	550	600	650	700	750	800	850	900	950	1000
Weight(kg)	10.33	10.83	11.33	11.83	12.33	12.83	13.33	13.83	14.33	14.83

Linear Electric Actuator

Series AVRS

Cat :

How to order

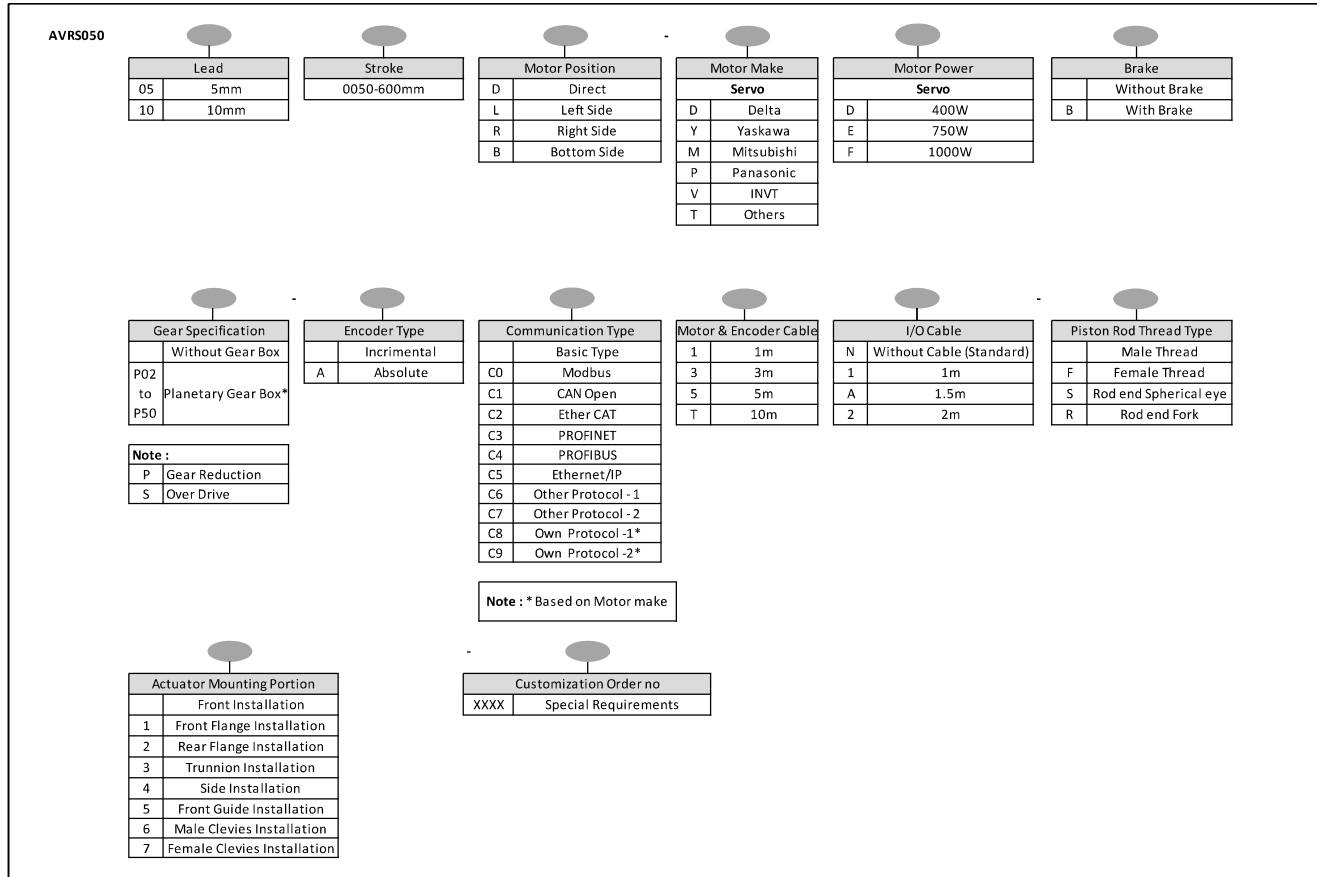

Example:1

Order no. for Rod type ball screw electric actuator VDMA 50mm size, 10mm Lead, 500mm stroke with Delta 750W servo motor mounted at the motor Direct, with 3m Motor & Encoder cable.

AVRS050100500D-DE-3N

Example:2

Order no. for Rod type ball screw electric actuator VDMA 50mm size, 10mm Lead, 500mm stroke without Delta 750W servo motor mounted at the motor Direct.

AVRS050100500D-DE

Linear Electric Actuator

Series AVRS

Cat :

Rod Type Ball Screw Actuator - Heavy Series - 63mm

Features

- Compact Robust Design
- Highly flexible mounting
- More Precise & positioning
- Ease of positioning
- Ease of Maintenance



Technical Specifications

Repeatability (mm)	±0.02									
Motor Power (W)	400									
Motor Speed (RPM)	3000									
Rated torque (N.m)	1.27									
Ball screw Lead (mm)	5					10				
Maximum Speed (mm/sec)*	250	125	83	500	250	167	125	100	83	71
Rated Thrust (N)	1360	2720	4080	680	1360	2040	2720	3400	4080	4760
Gear Ratio	1:1	2:1	3:1	1:1	2:1	3:1	4:1	5:1	6:1	7:1
Stroke (mm)	50-1200mm									
Ball Screw Ø (mm)	C7 Ø 20									
Home Sensor	Outside	AM42 Reed Switch								
Repeatability (mm)	±0.02									
Motor Power (W)	750					1000		1000	1500	1500
Motor Speed (RPM)	3000					3000		2000	3000	2000
Rated torque (N.m)	2.4					3.18		4.77	4.77	7.16
Ball screw Lead (mm)	5	10			5	10		10	10	10
Maximum Speed (mm/sec)*	250	500	250	167	250	500	250	333	500	333
Rated Thrust (N)	2562	1281	2562	3843	3395	1696	3394	2546	2546	3822
Gear Ratio	1:1	1:1	2:1	3:1	1:1	1:1	2:1	1:1	1:1	1:1
Stroke (mm)	50-1200mm									
Ball Screw Ø (mm)	C7 Ø 20									
Home Sensor	Outside	AM42 Reed Switch								

*Acceleration and deceleration value is set 0.2sec

Front End Connection:

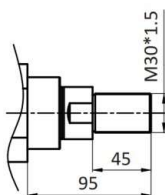

Male

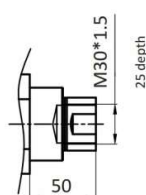

Female

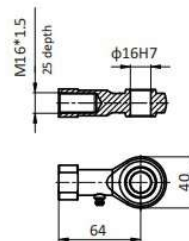

Rod end Spherical eye

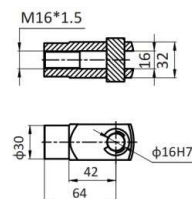

Rod end Fork

Linear Electric Actuator

Series AVRS

Cat :

Direct Front Installation

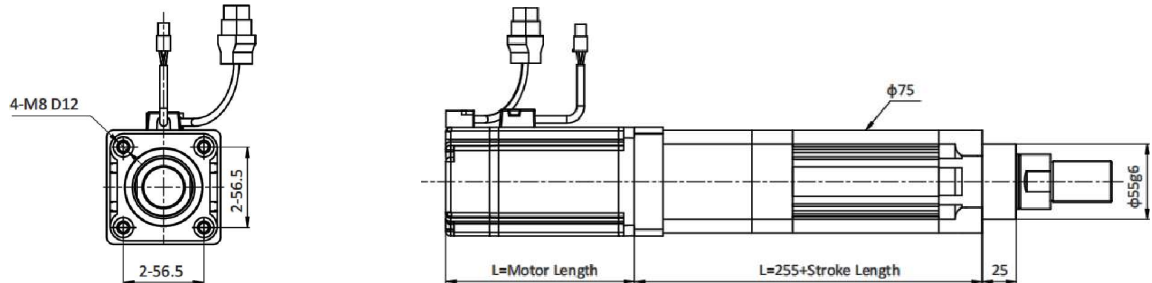

Stroke(mm)	50	100	150	200	250	300	350	400	450	500	550	600
Weight (Kg)	6.2	6.8	7.4	8	8.6	9.8	10.4	11	11.6	12.2	12.8	13.4
Stroke(mm)	650	700	750	800	850	900	950	1000	1050	1100	1150	1200
Weight (Kg)	14	14.6	15.2	15.8	16.4	17	17.6	18.2	18.8	19.4	20	20.6

Direct Front Flange Installation

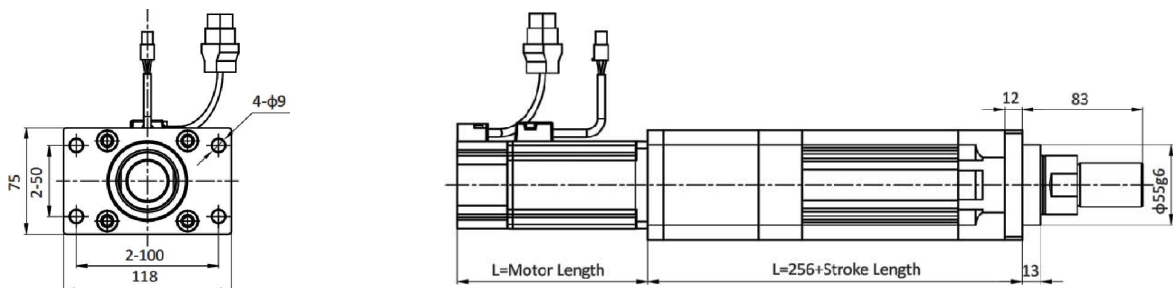

Stroke(mm)	50	100	150	200	250	300	350	400	450	500	550	600
Weight (Kg)	6.14	6.74	7.34	7.94	8.54	9.14	9.74	10.34	10.94	11.54	12.14	12.74
Stroke(mm)	650	700	750	800	850	900	950	1000	1050	1100	1150	1200
Weight (Kg)	13.34	13.94	14.54	15.14	15.74	16.34	16.94	17.54	18.14	18.74	19.34	19.94

Direct Rear Flange Installation

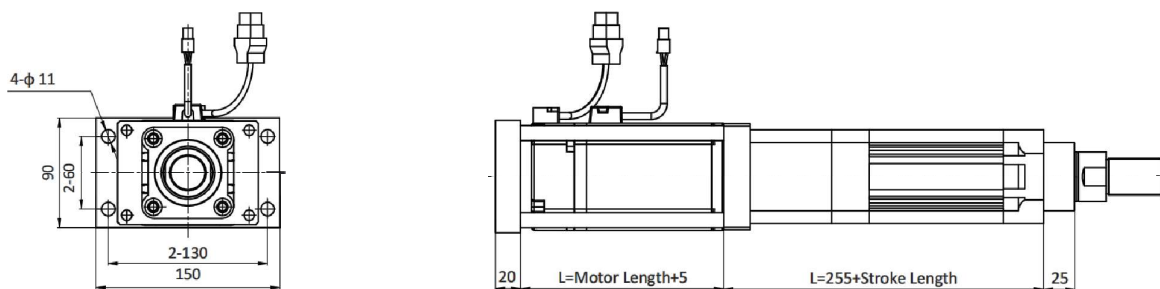

Stroke(mm)	50	100	150	200	250	300	350	400	450	500	550	600
Weight (Kg)	8.36	8.96	9.56	10.16	10.76	11.36	11.96	12.56	13.16	13.76	14.36	14.96
Stroke(mm)	650	700	750	800	850	900	950	1000	1050	1100	1150	1200
Weight (Kg)	15.56	16.16	16.76	17.36	17.96	18.56	19.16	19.76	20.36	20.96	21.56	22.16

Linear Electric Actuator

Series AVRS

Cat :

Direct Trunnion Installation

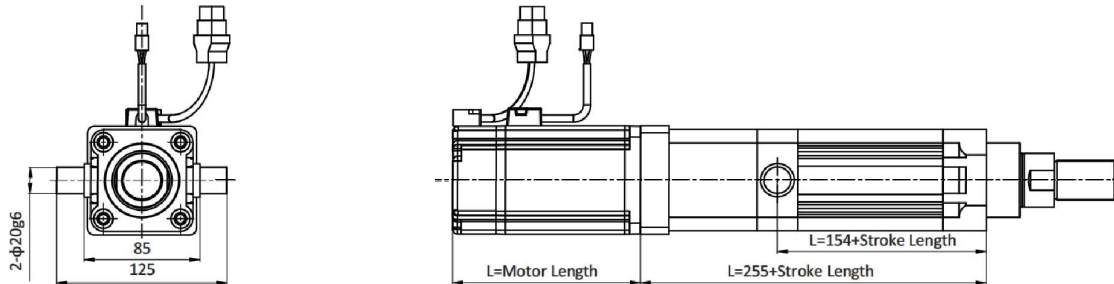

Stroke(mm)	50	100	150	200	250	300	350	400	450	500	550	600
Weight (Kg)	6.25	6.85	7.45	8.05	8.65	9.25	9.85	10.45	11.05	11.65	12.25	12.85
Stroke(mm)	650	700	750	800	850	900	950	1000	1050	1100	1150	1200
Weight (Kg)	13.45	14.05	14.65	15.25	15.85	16.45	17.05	17.65	18.25	18.85	19.45	20.05

Direct Side Installation

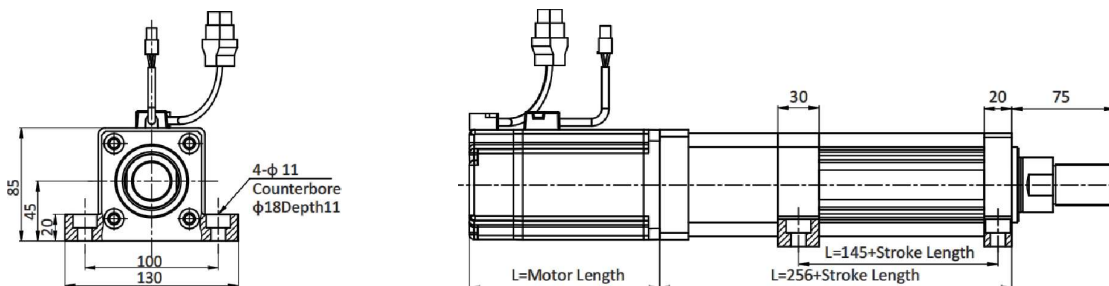

Stroke(mm)	50	100	150	200	250	300	350	400	450	500	550	600
Weight (Kg)	7.02	7.62	8.22	8.82	9.42	10.02	10.62	11.22	11.82	12.42	13.02	13.62
Stroke(mm)	650	700	750	800	850	900	950	1000	1050	1100	1150	1200
Weight (Kg)	14.02	14.62	15.02	15.62	16.02	16.62	17.02	17.62	18.02	18.62	19.02	19.62

Direct Front guide Installation

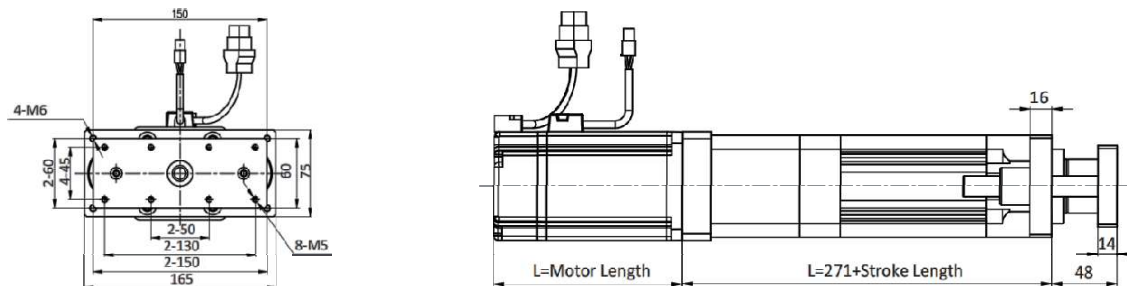

Stroke(mm)	50	100	150	200	250	300	350	400	450	500	550	600
Weight (Kg)	7.05	7.85	8.65	9.45	10.25	11.05	11.85	12.65	13.45	14.25	15.05	15.85
Stroke(mm)	650	700	750	800	850	900	950	1000	1050	1100	1150	1200
Weight (Kg)	16.65	17.45	18.25	19.05	19.85	20.65	21.45	22.25	23.05	23.85	24.65	25.45

Linear Electric Actuator

Series AVRS

Cat :

Direct Male Clevis Installation

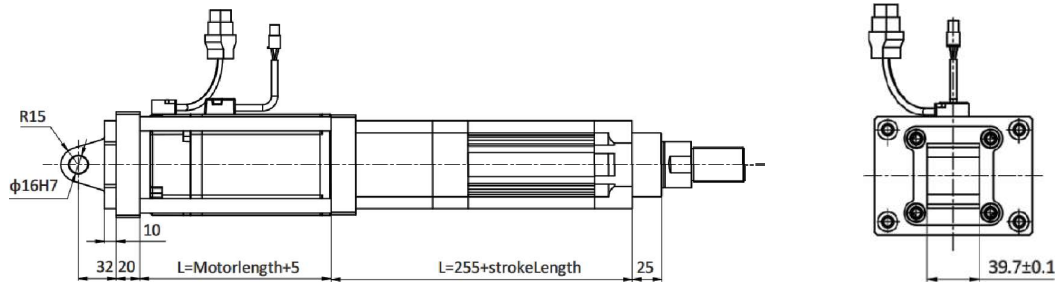

Stroke(mm)	50	100	150	200	250	300	350	400	450	500	550	600
Weight (Kg)	8.69	9.29	9.89	10.49	11.09	11.69	12.29	12.89	13.49	14.09	14.69	15.29
Stroke(mm)	650	700	750	800	850	900	950	1000	1050	1100	1150	1200
Weight (Kg)	15.89	16.49	17.09	17.69	18.29	18.89	19.49	20.9	20.69	21.29	21.89	22.49

Direct Female Clevis Installation

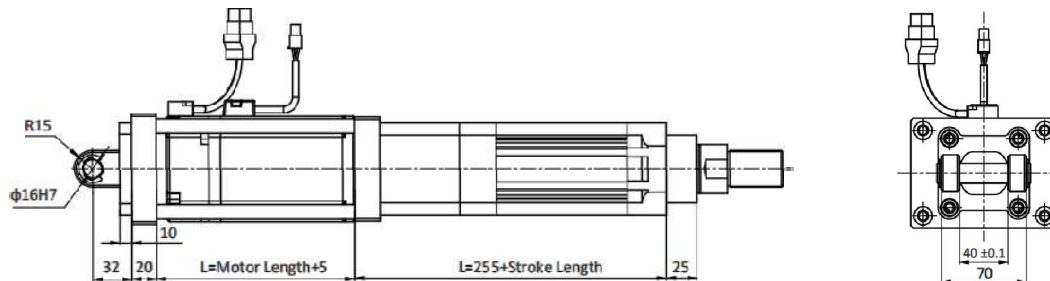

Stroke(mm)	50	100	150	200	250	300	350	400	450	500	550	600
Weight (Kg)	8.74	9.34	9.94	10.54	11.14	11.74	12.34	12.94	13.54	14.14	14.74	15.34
Stroke(mm)	650	700	750	800	850	900	950	1000	1050	1100	1150	1200
Weight (Kg)	15.94	16.54	17.14	17.74	18.34	18.94	19.54	20.14	20.74	21.34	21.94	22.54

Transition Front Installation

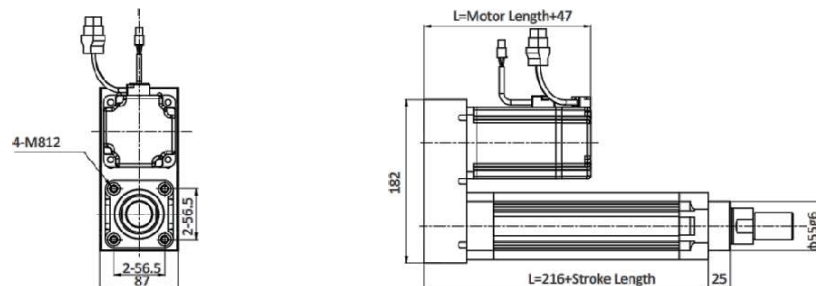

Stroke(mm)	50	100	150	200	250	300	350	400	450	500	550	600
Weight (Kg)	6.3	7.9	9.5	11.1	12.7	14.3	15.9	17.5	19.1	20.7	22.3	23.9
Stroke(mm)	650	700	750	800	850	900	950	1000	1050	1100	1150	1200
Weight (Kg)	25.5	27.1	28.7	30.3	31.9	33.5	35.1	36.7	38.3	39.9	41.5	43.1

Linear Electric Actuator

Series AVRS

Cat :

Transition Flange Installation

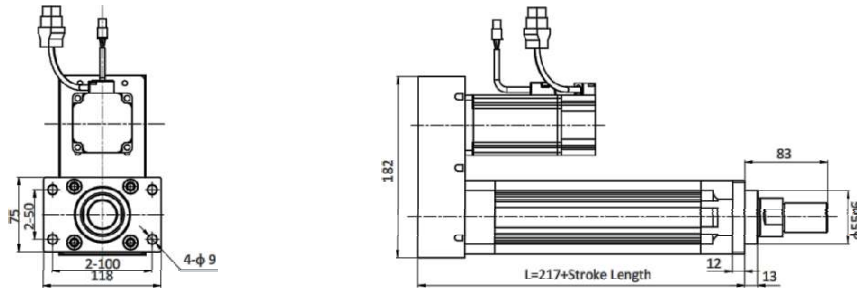

Stroke(mm)	50	100	150	200	250	300	350	400	450	500	550	600
Weight (Kg)	6.24	6.84	7.44	8.04	8.64	9.24	9.84	10.44	11.04	11.64	12.24	12.84
Stroke(mm)	650	700	750	800	850	900	950	1000	1050	1100	1150	1200
Weight (Kg)	13.44	14.04	14.64	15.24	15.84	16.44	17.04	17.64	18.24	18.84	19.44	20.04

Transition Rear Flange Installation

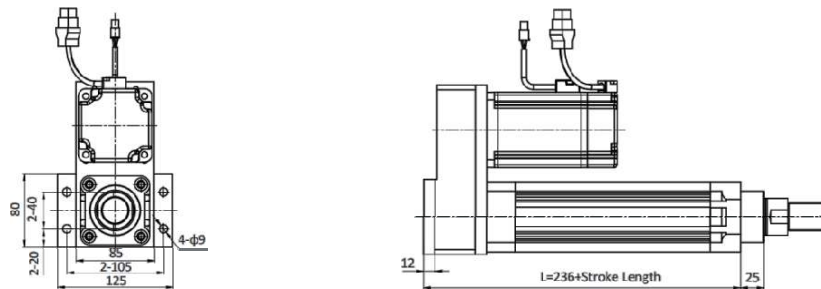

Stroke(mm)	50	100	150	200	250	300	350	400	450	500	550	600
Weight (Kg)	7.23	7.83	8.43	9.03	9.63	10.23	10.83	11.43	12.03	12.63	13.23	13.83
Stroke(mm)	650	700	750	800	850	900	950	1000	1050	1100	1150	1200
Weight (Kg)	14.43	15.03	15.63	16.23	16.83	17.43	18.03	18.63	19.23	19.83	20.43	21.03

Transition Trunnion Installation

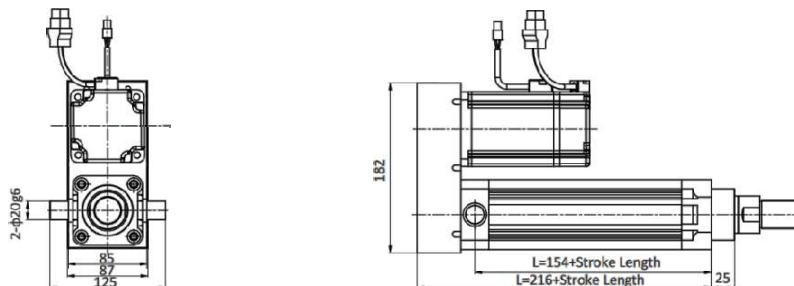

Stroke(mm)	50	100	150	200	250	300	350	400	450	500	550	600
Weight (Kg)	6.35	6.95	7.55	8.15	8.75	9.35	9.95	10.55	11.15	11.75	12.35	12.95
Stroke(mm)	650	700	750	800	850	900	950	1000	1050	1100	1150	1200
Weight (Kg)	13.55	14.15	14.75	15.35	15.95	16.55	17.15	17.75	18.35	18.95	19.55	20.15

Linear Electric Actuator

Series AVRS

Cat :

Transition Side Installation

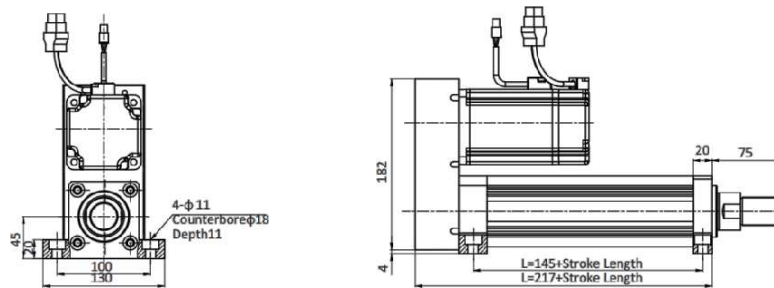

Stroke(mm)	50	100	150	200	250	300	350	400	450	500	550	600
Weight (Kg)	7.12	7.72	8.32	8.92	9.52	10.12	10.72	11.32	11.92	12.52	13.12	13.72
Stroke(mm)	650	700	750	800	850	900	950	1000	1050	1100	1150	1200
Weight (Kg)	14.32	14.92	15.52	16.12	16.72	17.32	17.92	18.52	19.12	19.72	20.32	20.92

Transition Front Guide Installation

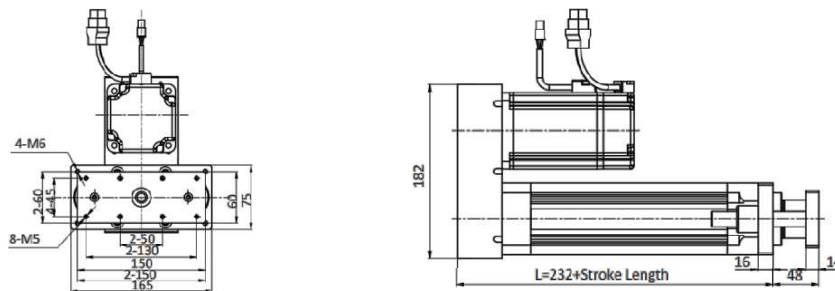

Stroke(mm)	50	100	150	200	250	300	350	400	450	500	550	600
Weight (Kg)	7.15	7.95	8.75	9.55	10.35	11.15	11.95	12.75	13.55	14.35	15.15	15.95
Stroke(mm)	650	700	750	800	850	900	950	1000	1050	1100	1150	1200
Weight (Kg)	16.75	17.55	18.35	19.15	19.95	20.75	21.55	22.35	23.15	23.95	24.75	25.55

Transition Male Clevis Installation

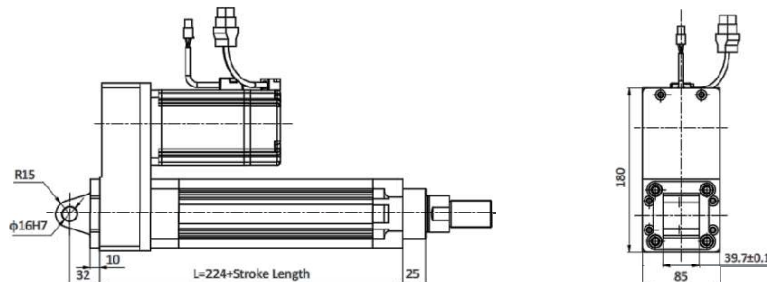

Stroke(mm)	50	100	150	200	250	300	350	400	450	500	550	600
Weight (Kg)	7.52	8.12	8.72	9.32	9.92	10.52	11.12	11.72	12.32	12.92	13.52	14.12
Stroke(mm)	650	700	750	800	850	900	950	1000	1050	1100	1150	1200
Weight (Kg)	14.72	15.32	15.92	16.52	17.12	17.72	18.32	18.92	19.52	20.12	20.72	21.32

Linear Electric Actuator

Series AVRS

Cat :

Transition Female Clevis Installation

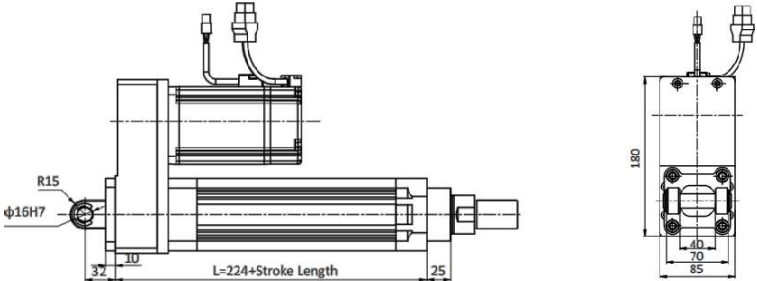

Stroke(mm)	50	100	150	200	250	300	350	400	450	500	550	600
Weight (Kg)	7,58	8,18	8,78	9,38	9,98	10,58	11,18	11,78	12,38	12,98	13,58	14,18
Stroke(mm)	650	700	750	800	850	900	950	1000	1050	1100	1150	1200
Weight (Kg)	14,78	15,38	15,98	16,58	17,18	17,78	18,38	18,98	19,58	20,18	20,78	21,38

Linear Electric Actuator

Series AVRS

Cat :

How to Order

AVRS063

Lead		Stroke		Motor Position		Motor Make		Motor Power		Brake	
05	5mm	0050-1000mm		D	Direct	Servo		Servo			Without Brake
10	10mm			L	Left Side	D	Delta	D	400W	B	With Brake
				R	Right Side	Y	Yaskawa	E	750W		
				B	Bottom Side	M	Mitsubishi	F	1KW		
						P	Panasonic	G	1.5KW		
						V	INVT				
						T	Others				

Gear Specification		Encoder Type		Communication Type		Motor & Encoder Cable		I/O Cable		Piston Rod Thread Type	
Without Gear Box		Incremental		Basic Type		1	1m	N	Without Cable (Standard)	Male Thread	
P02 to P50	Planetary Gear Box*	A	Absolute	C0	Modbus	3	3m	1	1m	F	Female Thread
				C1	CAN Open	5	5m	A	1.5m	S	Rod end Spherical eye
				C2	Ether CAT	T	10m	2	2m	R	Rod end Fork
				C3	PROFINET						
				C4	PROFIBUS						
				C5	Ethernet/IP						
				C6	Other Protocol -1						
				C7	Other Protocol -2						
				C8	Own Protocol -1*						
				C9	Own Protocol -2*						

Note :

P	Gear Reduction
S	Over Drive

Note : * Based on Motor make

Actuator Mounting Portion		Customization Order no	
Front Installation		XXXX	Special Requirements
1	Front Flange Installation		
2	Rear Flange Installation		
3	Trunnion Installation		
4	Side Installation		
5	Front Guide Installation		
6	Male Clevis Installation		
7	Female Clevis Installation		

Example:1

Order no. for Rod type ball screw electric actuator VDMA 63mm size, 10mm Lead, 500mm stroke with Delta 750W servo motor mounted at the motor Direct, with 3m Motor & Encoder cable.

AVRS063100500D-DE-3N

Example:2

Order no. for Rod type ball screw electric actuator VDMA 63mm size, 10mm Lead, 500mm stroke without Delta 750W servo motor mounted at the motor Direct.

AVRS063100500D-DE

Linear Electric Actuator

Series AVRS

Cat :

Rod Type Ball Screw Actuator - Heavy Series - 80mm

Features

- ❑ Compact Robust Design
- ❑ Highly flexible mounting
- ❑ More Precise & positioning
- ❑ Ease of positioning
- ❑ Ease of Maintenance



Technical Specifications

Repeatability (mm)	±0.02											
Motor Power (W)	1000						1000			1500		
Motor Speed (RPM)	3000						2000			3000		
Rated torque (N.m)	3.18						4.77			4.77		
Ball screw Lead (mm)	5			10			5		10		5	
Maximum Speed (mm/sec)*	250	125	500	250	167	125	100	167	333	167	111	250
Rated Thrust (N)	339 5	6790	1697	3394	5091	6788	8485	5092	2546	5092	7638	5092
Gear Ratio	1:1	2:1	1:1	2:1	3:1	4:1	5:1	1:1	1:1	2:1	3:1	1:1
Stroke (mm)	50-2000 mm											
Ball Screw Ø (mm)	C7 Ø 25											
Home Sensor	Outside	AM42 Reed Switch										
Repeatability (mm)	±0.02											
Motor Power (W)	1500			1500			2000		2000	3000	3000	
Motor Speed (RPM)	3000			2000			3000		2000	3000	2000	
Rated torque (N.m)	4.77			7.16			6.37		9.55	9.55	14.32	
Ball screw Lead (mm)	10			5	10		5	10		10	10	10
Maximum Speed (mm/sec)*	500	250	167	167	333	167	250	500	250	333	500	333
Rated Thrust (N)	254 6	5092	7638	7644	3822	7644	6800	3400	6800	5098	5098	7644
Gear Ratio	1:1	2:1	3:1	1:1	1:1	2:1	1:1	1:1	2:1	1:1	1:1	1:1
Stroke (mm)	50-2000 mm											
Ball Screw Ø (mm)	C7 Ø 25											
Home Sensor	Outside	AM42 Reed Switch										

*Acceleration and deceleration value is set 0.2sec

Front End Connection :

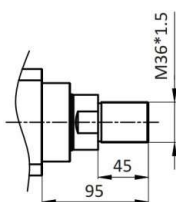

Male

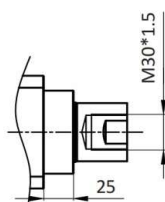

Female

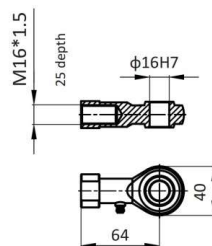

Rod End Spherical Eye

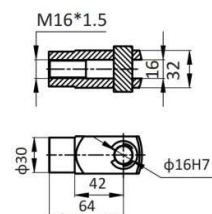

Rod End Fork

Linear Electric Actuator

Series AVRS

Cat :

Direct Front Installation:

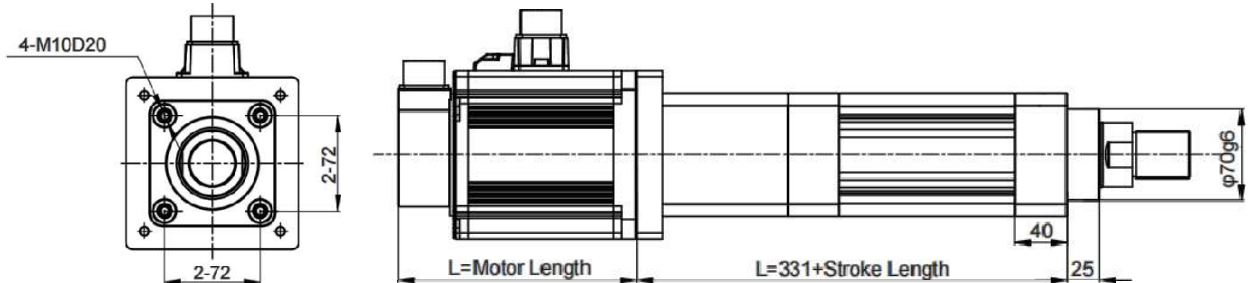

Stroke (mm)	50	100	150	200	250	300	350	400	450	500	550	600	650	700	750	800	850	900	950	1000
Weight (Kg)	12.11	13.2	14.15	15.1	16.05	17	17.95	18.9	19.85	20.8	21.75	22.7	23.65	24.6	25.55	26.5	27.45	28.4	29.35	30.3
Stroke (mm)	1050	1100	1150	1200	1250	1300	1350	1400	1450	1500	1550	1600	1650	1700	1750	1800	1850	1900	1950	2000
Weight (Kg)	31.25	32.2	33.15	34.1	35.05	36	36.95	37.9	38.85	39.8	40.75	41.7	42.65	43.6	44.55	45.5	46.45	47.4	48.48	49.3

Direct Front Flange Installation:

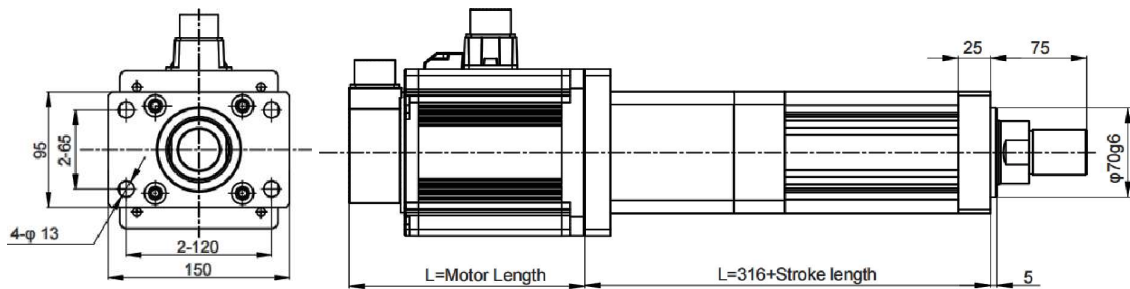

Stroke (mm)	50	100	150	200	250	300	350	400	450	500	550	600	650	700	750	800	850	900	950	1000
Weight (Kg)	12.11	13.06	14.01	14.96	15.91	16.86	17.81	18.76	19.71	20.66	21.61	22.56	23.51	24.46	25.41	26.36	27.31	28.26	29.21	30.16
Stroke (mm)	1050	1100	1150	1200	1250	1300	1350	1400	1450	1500	1550	1600	1650	1700	1750	1800	1850	1900	1950	2000
Weight (Kg)	31.11	32.06	33.01	33.96	34.91	35.86	36.81	37.76	38.71	39.66	40.61	41.56	42.51	43.46	44.41	45.36	46.31	47.26	48.21	49.16

Direct Rear Flange Installation:

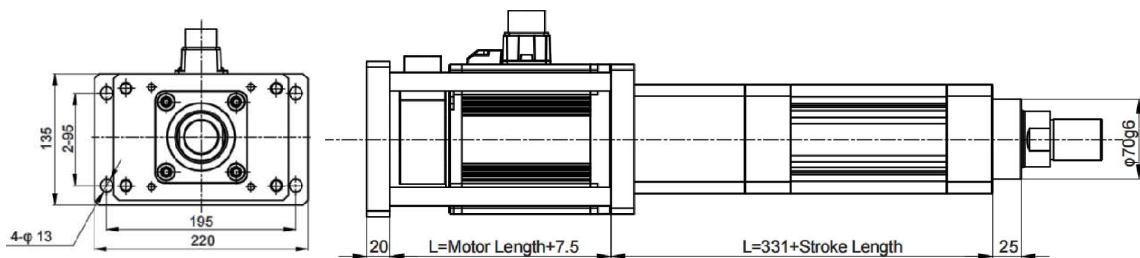

Stroke (mm)	50	100	150	200	250	300	350	400	450	500	550	600	650	700	750	800	850	900	950	1000
Weight (Kg)	15.37	16.32	17.27	18.22	19.17	20.12	21.07	22.02	22.97	23.92	24.87	25.82	26.77	27.72	28.67	29.62	30.57	31.52	32.47	33.42
Stroke (mm)	1050	1100	1150	1200	1250	1300	1350	1400	1450	1500	1550	1600	1650	1700	1750	1800	1850	1900	1950	2000
Weight (Kg)	34.37	35.32	36.27	37.22	38.17	39.12	40.07	41.02	41.97	42.92	43.87	44.82	45.77	46.72	47.67	48.62	49.57	50.52	51.47	52.42

Linear Electric Actuator

Series AVRS

Cat :

Direct Trunnion Installation:

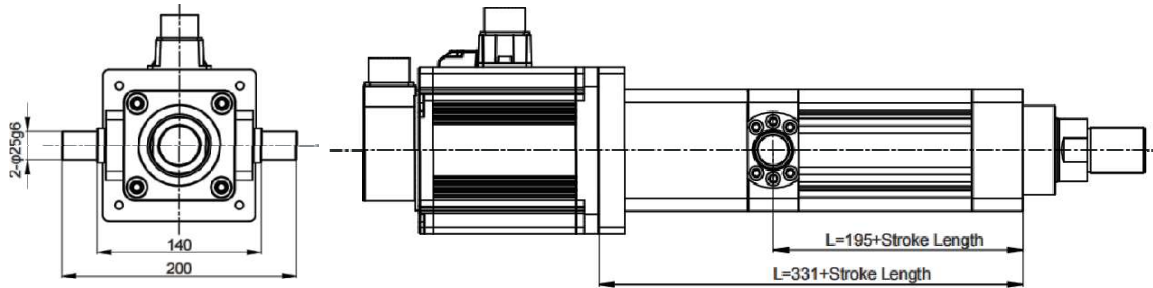

Stroke (mm)	50	100	150	200	250	300	350	400	450	500	550	600	650	700	750	800	850	900	950	1000
Weight (Kg)	12.09	13.04	13.99	14.94	15.89	16.84	17.79	18.74	19.69	20.64	21.59	22.54	23.49	24.44	25.39	26.34	27.29	28.24	29.19	30.14
Stroke (mm)	1050	1100	1150	1200	1250	1300	1350	1400	1450	1500	1550	1600	1650	1700	1750	1800	1850	1900	1950	2000
Weight (Kg)	31.09	32.04	32.99	33.94	34.89	35.84	36.79	37.74	38.69	39.64	40.59	41.54	42.49	43.44	44.39	45.34	46.29	47.24	48.19	49.14

Direct Side Installation :

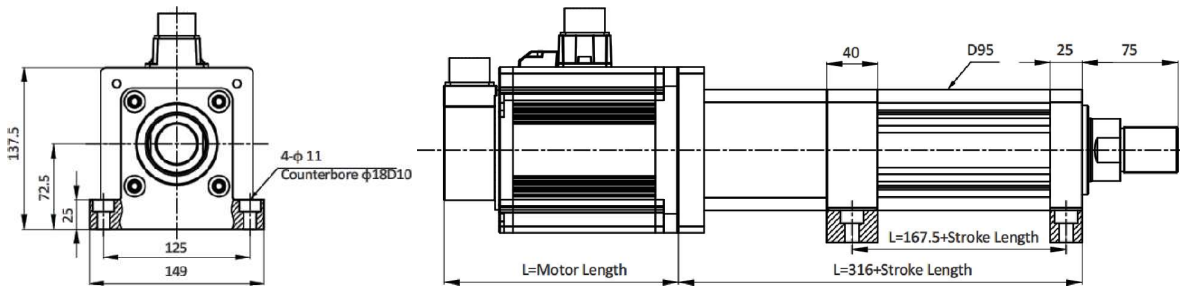

Stroke (mm)	50	100	150	200	250	300	350	400	450	500	550	600	650	700	750	800	850	900	950	1000
Weight (Kg)	12.41	13.36	14.31	15.26	16.21	17.16	18.11	19.06	20.01	20.96	21.91	22.86	23.81	24.76	25.71	26.66	27.61	28.56	29.51	30.46
Stroke (mm)	1050	1100	1150	1200	1250	1300	1350	1400	1450	1500	1550	1600	1650	1700	1750	1800	1850	1900	1950	2000
Weight (Kg)	31.41	32.36	33.31	34.26	35.21	36.16	37.11	38.06	39.01	39.96	40.91	41.86	42.81	43.76	44.71	45.66	46.61	47.56	48.51	49.46

Direct Front Guide Installation :

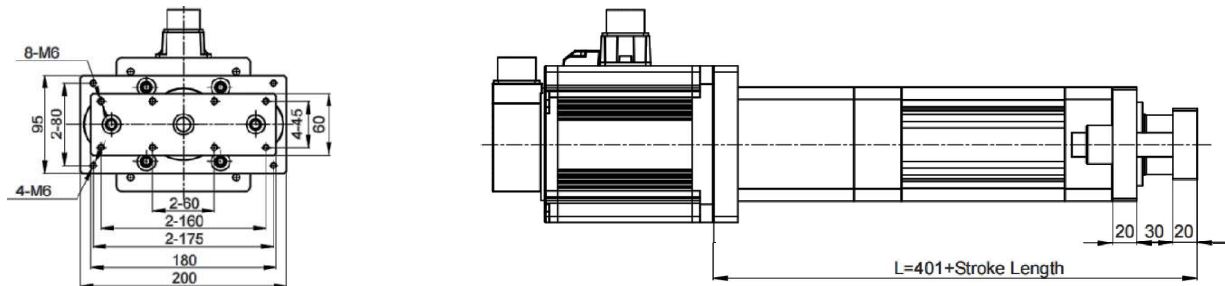

Stroke (mm)	50	100	150	200	250	300	350	400	450	500	550	600	650	700	750	800	850	900	950	1000
Weight (Kg)	13.74	14.94	16.14	17.34	18.54	19.74	20.94	22.14	23.34	24.54	25.74	26.94	28.14	29.34	30.54	31.74	32.94	34.14	35.34	36.54
Stroke (mm)	1050	1100	1150	1200	1250	1300	1350	1400	1450	1500	1550	1600	1650	1700	1750	1800	1850	1900	1950	2000
Weight (Kg)	37.74	38.94	40.14	41.34	42.54	43.74	44.94	46.14	47.34	48.54	49.74	50.94	52.14	53.34	54.54	55.74	56.94	58.14	59.34	60.54

Linear Electric Actuator

Series AVRS

Cat :

Direct Male Clevis Installation :

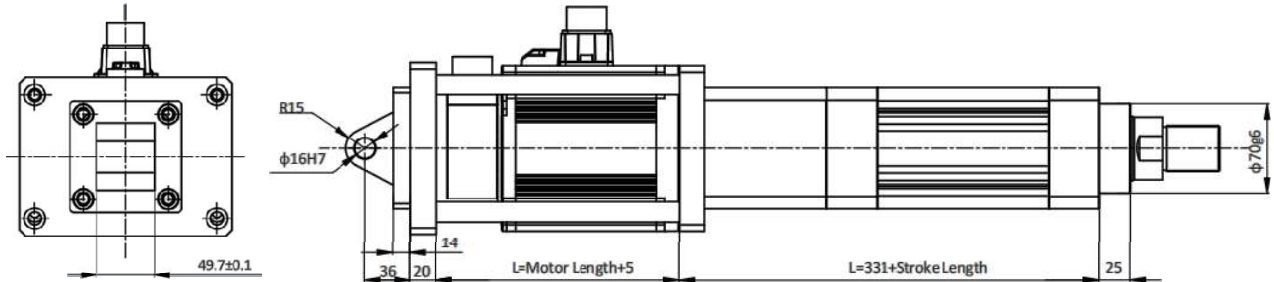

Stroke (mm)	50	100	150	200	250	300	350	400	450	500	550	600	650	700	750	800	850	900	950	1000
Weight (Kg)	16.41	17.36	18.31	19.26	20.21	21.16	22.11	23.06	24.01	24.96	25.91	26.86	27.81	28.76	29.71	30.66	31.61	32.56	33.51	34.46
Stroke (mm)	1050	1100	1150	1200	1250	1300	1350	1400	1450	1500	1550	1600	1650	1700	1750	1800	1850	1900	1950	2000
Weight (Kg)	35.41	36.36	37.31	38.26	39.21	40.16	41.11	42.06	43.01	43.96	44.91	45.86	46.81	47.76	48.71	49.66	50.61	51.56	52.51	53.46

Direct Female Clevis Installation:

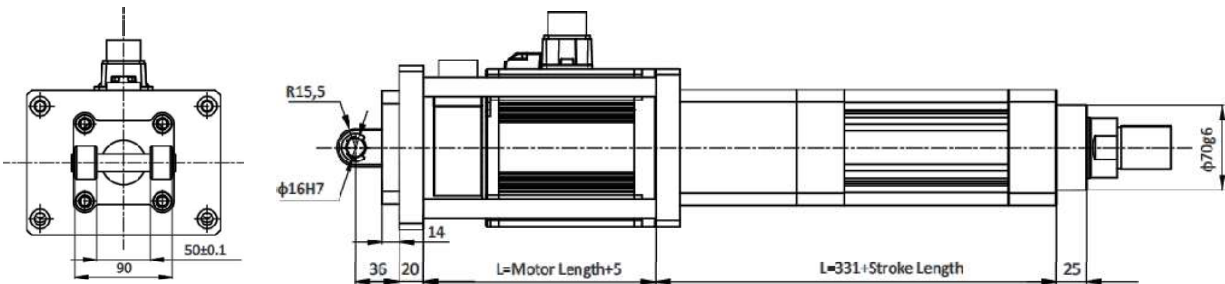

Stroke (mm)	50	100	150	200	250	300	350	400	450	500	550	600	650	700	750	800	850	900	950	1000
Weight (Kg)	15.97	16.92	17.87	18.82	19.77	20.72	21.67	22.62	23.57	24.52	25.47	26.42	27.37	28.32	29.27	30.22	31.17	32.12	33.07	34.02
Stroke (mm)	1050	1100	1150	1200	1250	1300	1350	1400	1450	1500	1550	1600	1650	1700	1750	1800	1850	1900	1950	2000
Weight (Kg)	34.97	35.92	36.87	37.82	38.77	39.72	40.67	41.62	42.57	43.52	44.47	45.42	46.37	47.32	48.27	49.22	50.17	51.12	52.07	53.02

Transition Front Installation :

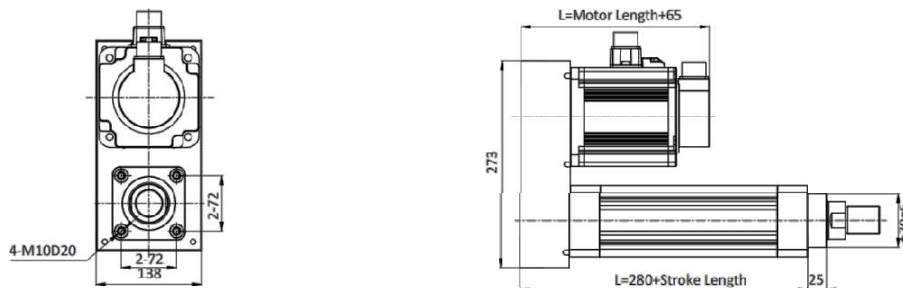

Stroke (mm)	50	100	150	200	250	300	350	400	450	500	550	600	650	700	750	800	850	900	950	1000
Weight (Kg)	13.40	14.35	15.30	16.25	17.20	18.15	19.10	20.05	21.00	21.95	22.90	23.85	24.80	25.75	26.70	27.65	28.60	29.55	30.50	31.45
Stroke (mm)	1050	1100	1150	1200	1250	1300	1350	1400	1450	1500	1550	1600	1650	1700	1750	1800	1850	1900	1950	2000
Weight (Kg)	32.40	33.35	34.30	35.25	36.20	37.15	38.10	39.05	40.00	40.95	41.90	42.85	43.80	44.75	45.70	46.65	47.60	48.55	49.50	50.45

Linear Electric Actuator

Series AVRS

Cat :

Transition Front Flange Installation :

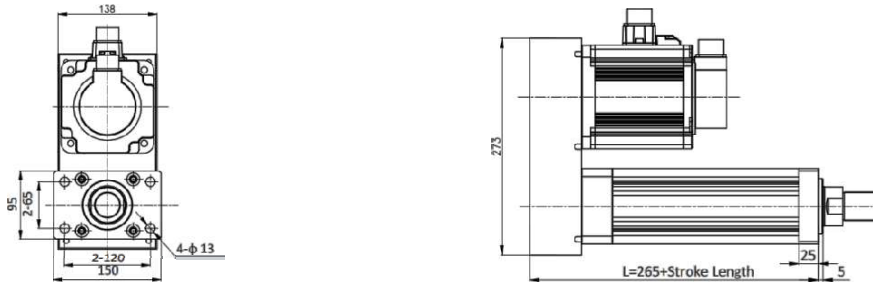

Stroke (mm)	50	100	150	200	250	300	350	400	450	500	550	600	650	700	750	800	850	900	950	1000
Weight (Kg)	12.50	13.45	14.40	15.35	16.30	17.25	18.20	19.15	20.10	21.05	22.00	22.95	23.90	24.85	25.80	26.75	27.70	28.65	29.60	30.55
Stroke (mm)	1050	1100	1150	1200	1250	1300	1350	1400	1450	1500	1550	1600	1650	1700	1750	1800	1850	1900	1950	2000
Weight (Kg)	31.50	32.45	33.40	34.35	35.30	36.25	37.20	38.15	39.10	40.05	41.00	41.95	42.90	43.85	44.80	45.75	46.70	47.65	48.60	49.55

Transition Rear Flange Installation :

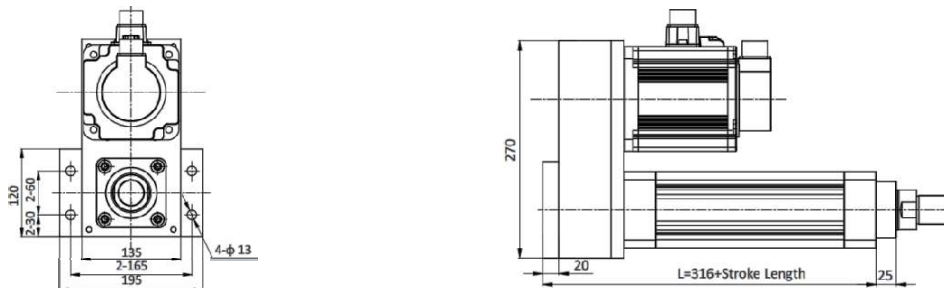

Stroke (mm)	50	100	150	200	250	300	350	400	450	500	550	600	650	700	750	800	850	900	950	1000
Weight (Kg)	15.33	16.28	17.23	18.18	19.13	20.08	21.03	21.98	22.93	23.88	24.83	25.78	26.73	27.68	28.63	29.58	30.53	31.48	32.43	33.38
Stroke (mm)	1050	1100	1150	1200	1250	1300	1350	1400	1450	1500	1550	1600	1650	1700	1750	1800	1850	1900	1950	2000
Weight (Kg)	34.33	35.28	36.23	37.18	38.13	39.08	40.03	40.98	41.93	42.88	43.83	44.78	45.73	46.68	47.63	48.58	49.53	50.48	51.43	52.38

Transition Side Installation :

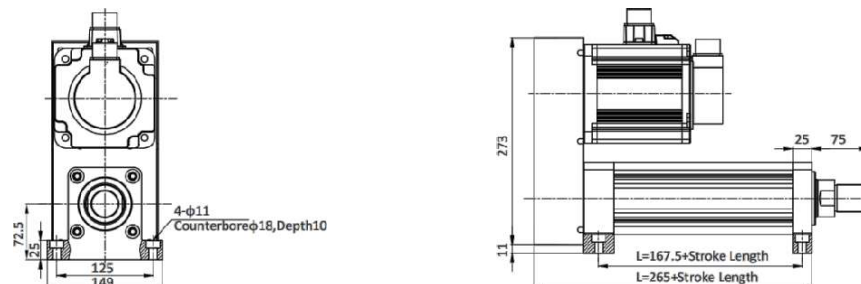

Stroke (mm)	50	100	150	200	250	300	350	400	450	500	550	600	650	700	750	800	850	900	950	1000
Weight (Kg)	13.96	14.91	15.86	16.81	17.76	18.71	19.66	20.61	21.56	22.51	23.46	24.41	25.36	26.31	27.26	28.21	29.16	30.11	31.06	32.01
Stroke (mm)	1050	1100	1150	1200	1250	1300	1350	1400	1450	1500	1550	1600	1650	1700	1750	1800	1850	1900	1950	2000
Weight (Kg)	32.96	33.91	34.86	35.81	36.76	37.71	38.66	39.61	40.56	41.51	42.46	43.41	44.36	45.31	46.26	47.21	48.16	49.11	50.06	51.01

Linear Electric Actuator

Series AVRS

Cat :

Transition Trunnion Installation :

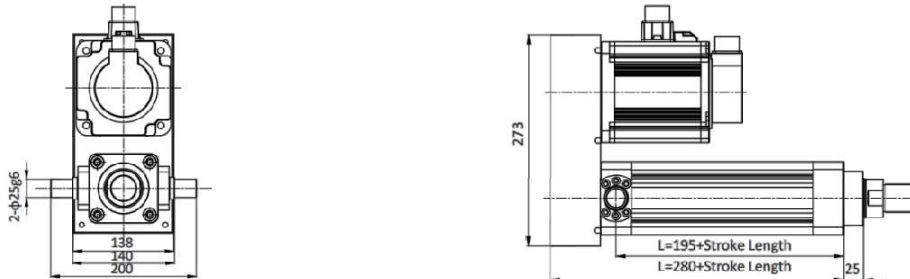

Stroke (mm)	50	100	150	200	250	300	350	400	450	500	550	600	650	700	750	800	850	900	950	1000
Weight (Kg)	13.96	14.91	15.86	16.81	17.76	18.71	19.66	20.61	21.56	22.51	23.46	24.41	25.36	26.31	27.26	28.21	29.16	30.11	31.06	32.01
Stroke (mm)	1050	1100	1150	1200	1250	1300	1350	1400	1450	1500	1550	1600	1650	1700	1750	1800	1850	1900	1950	2000
Weight (Kg)	32.96	33.91	34.86	35.81	36.76	37.71	38.66	39.61	40.56	41.51	42.46	43.41	44.36	45.31	46.26	47.21	48.16	49.11	50.06	51.01

Transition Front Guide Installation :

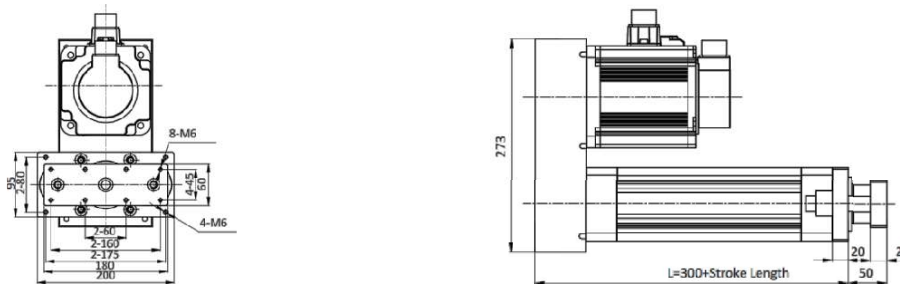

Stroke (mm)	50	100	150	200	250	300	350	400	450	500	550	600	650	700	750	800	850	900	950	1000
Weight (Kg)	13.96	14.91	15.86	16.81	17.76	18.71	19.66	20.61	21.56	22.51	23.46	24.41	25.36	26.31	27.26	28.21	29.16	30.11	31.06	32.01
Stroke (mm)	1050	1100	1150	1200	1250	1300	1350	1400	1450	1500	1550	1600	1650	1700	1750	1800	1850	1900	1950	2000
Weight (Kg)	32.96	33.91	34.86	35.81	36.76	37.71	38.66	39.61	40.56	41.51	42.46	43.41	44.36	45.31	46.26	47.21	48.16	49.11	50.06	51.01

Transition Male Clevis Installation :

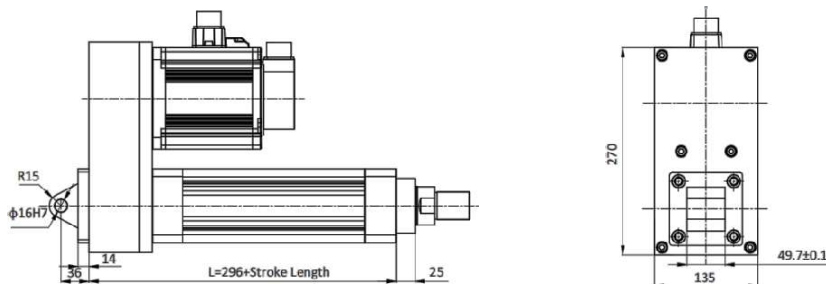

Stroke (mm)	50	100	150	200	250	300	350	400	450	500	550	600	650	700	750	800	850	900	950	1000
Weight (Kg)	14.72	15.67	16.62	17.57	18.52	19.47	20.42	21.37	22.32	23.27	24.22	25.17	26.12	27.07	28.02	28.97	29.92	30.87	31.82	32.77
Stroke (mm)	1050	1100	1150	1200	1250	1300	1350	1400	1450	1500	1550	1600	1650	1700	1750	1800	1850	1900	1950	2000
Weight (Kg)	33.72	34.67	35.62	36.57	37.52	38.47	39.42	40.37	41.32	42.27	43.22	44.17	45.12	46.07	47.02	47.97	48.92	49.87	50.82	51.77

Linear Electric Actuator

Series AVRS

Cat :

Transition Female Clevis Installation :

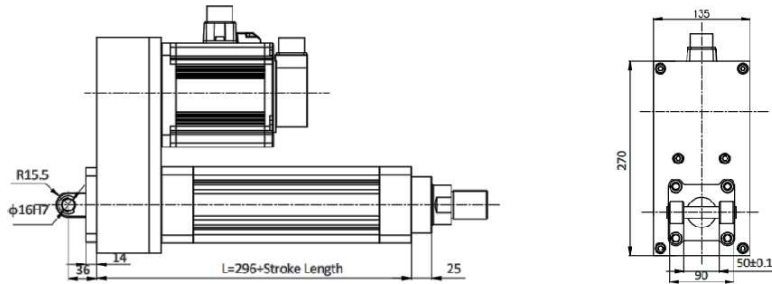

Stroke (mm)	50	100	150	200	250	300	350	400	450	500	550	600	650	700	750	800	850	900	950	1000
Weight (Kg)	14.28	15.23	16.18	17.13	18.08	19.03	19.98	20.93	21.88	22.83	23.78	24.73	25.68	26.63	27.58	28.53	29.48	30.43	31.38	32.33
Stroke (mm)	1050	1100	1150	1200	1250	1300	1350	1400	1450	1500	1550	1600	1650	1700	1750	1800	1850	1900	1950	2000
Weight (Kg)	33.28	34.23	35.18	36.13	37.08	38.03	38.98	39.93	40.88	41.83	42.78	43.73	44.68	45.63	46.58	47.53	48.48	49.43	50.38	51.33

Linear Electric Actuator

Series AVRS

Cat :

How to Order

AVRS080

Lead	
05	5mm
10	10mm

Stroke	
0050-1000mm	

Motor Position	
D	Direct
L	Left Side
R	Right Side
B	Bottom Side

Motor Make	
Servo	
D	Delta
Y	Yaskawa
M	Mitsubishi
P	Panasonic
V	INVT
T	Others

Motor Power	
Servo	
F	1KW
G	1.5KW
H	2KW
J	3KW

Brake	
	Without Brake
B	With Brake

Gear Specification	
Nil	Without Gear Box
P02 to P50	Planetary Gear Box*

Encoder Type	
	Incremental
A	Absolute

Communication Type	
Basic Type	
C0	Modbus
C1	CAN Open
C2	Ether CAT
C3	PROFINET
C4	PROFIBUS
C5	Ethernet/IP
C6	Other Protocol -1
C7	Other Protocol -2
C8	Own Protocol -1*
C9	Own Protocol -2*

Motor & Encoder Cable	
1	1m
3	3m
5	5m
T	10m

I/O Cable	
Without Cable (Standard)	
1	1m
A	1.5m
2	2m

Piston Rod Thread Type	
Male Thread	
F	Female Thread
S	Rod end Spherical eye
R	Rod end Fork

Note :

P	Gear Reduction
S	Over Drive

Note : * Based on Motor make

Actuator Mounting Portion	
Front Installation	
1	Front Flange Installation
2	Rear Flange Installation
3	Trunnion Installation
4	Side Installation
5	Front Guide Installation
6	Male Clevis Installation
7	Female Clevis Installation

Customization Order no	
XXXX	Special Requirements

Example:1

Order no. for Rod type ball screw electric actuator VDMA 80mm size, 10mm Lead, 500mm stroke with Delta 1.5KW servo motor mounted at the motor Direct, with 3m Motor & Encoder cable.

AVRS080100500D-DG-3N

Example:2

Order no. for Rod type ball screw electric actuator VDMA 80mm size, 10mm Lead, 500mm stroke without Delta 1.5KW servo motor mounted at the motor Direct.

AVRS080100500D-DG

Linear Electric Actuator

Series AVRS

Cat :

Rod Type Ball Screw Actuator - Heavy Series - 100mm

Features

- Compact Robust Design
- Highly flexible mounting
- More Precise & positioning
- Ease of positioning
- Ease of Maintenance



Technical Specifications

Repeatability (mm)	±0.02															
Motor Power (W)	1000											1000				
Motor Speed (RPM)	3000											2000				
Rated torque (N.m)	3.18											4.77				
Ball screw Lead (mm)	5				10								5			
Maximum Speed (mm/sec)*	250	125	83	63	500	250	167	125	100	83	71	63	167	84		
Rated Thrust (N)	3395	6790	10185	13580	1697	3394	5091	6788	8485	10812	11879	13576	5092	10184		
Gear Ratio	1:1	2:1	3:1	4:1	1:1	2:1	3:1	4:1	5:1	6:1	7:1	8:1	1:1	2:1		
Stroke (mm)	50-2000 mm															
Ball screw Ø (mm)	C7 Ø 32															
Home Sensor	Outside	AM42 Reed Switch														
Repeatability (mm)	±0.02															
Motor Power (W)	1000											1500				
Motor Speed (RPM)	2000											3000				
Rated torque (N.m)	4.77											7.16				
Ball screw Lead (mm)	10				5				10				5			
Maximum Speed (mm/sec)*	333	167	111	83	67	250	125	500	250	167	125	100	167	84		
Rated Thrust (N)	2546	5092	7638	10184	12730	5092	10184	2546	5092	7638	10184	12730	7644	15288		
Gear Ratio	1:1	2:1	3:1	4:1	5:1	1:1	2:1	1:1	2:1	3:1	4:1	5:1	1:1	2:1		
Stroke (mm)	50-2000 mm															
Ball screw Ø (mm)	C7 Ø 32															
Home Sensor	Outside	AM42 Reed Switch														
Repeatability (mm)	±0.02															
Motor Power (W)	1500				2000				2000				3000		3000	
Motor Speed (RPM)	2000				3000				2000				3000		2000	
Rated torque (N.m)	7.16				6.37				9.55				9.55		14.32	
Ball screw Lead (mm)	10				5				10				5		10	
Maximum Speed (mm/sec)*	333	167	111	250	125	500	250	167	125	167	333	167	250	500	250	333
Rated Thrust (N)	3822	7644	11466	6800	13600	3400	6800	10200	13600	10196	5098	10196	10196	5098	10196	7644
Gear Ratio	1:1	2:1	3:1	1:1	2:1	1:1	2:1	3:1	4:1	1:1	1:1	2:1	1:1	1:1	2:1	1:1
Stroke (mm)	50-2000 mm															
Ball screw Ø (mm)	C7 Ø 32															
Home Sensor	Outside	AM42 Reed Switch														

*Acceleration and deceleration value is set 0.2sec

Linear Electric Actuator

Series AVRS

Cat :

Front End Connection:

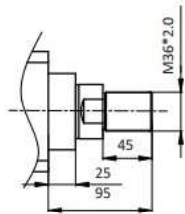

Male

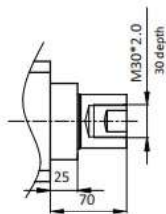

Female

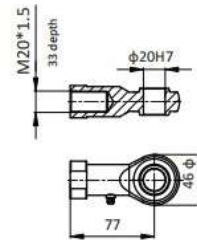

Rod end Spherical eye

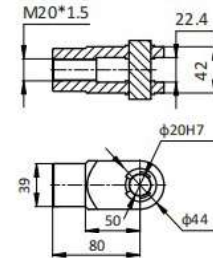

Rod end Fork

Direct Front Installation :

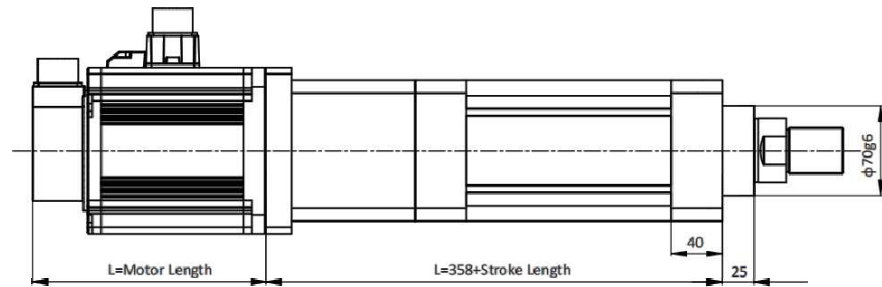
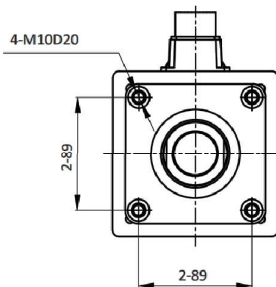

Stroke (mm)	50	100	150	200	250	300	350	400	450	500	550	600	650	700	750	800	850	900	950	1000
Weight (Kg)	17.16	18.26	19.36	20.46	21.56	22.66	23.76	24.86	25.96	27.06	28.16	29.26	30.36	31.46	32.56	33.66	34.76	35.86	36.96	38.06
Stroke (mm)	1050	1100	1150	1200	1250	1300	1350	1400	1450	1500	1550	1600	1650	1700	1750	1800	1850	1900	1950	2000
Weight (Kg)	39.16	40.26	41.36	42.46	43.56	44.66	45.76	46.86	47.96	49.06	50.16	51.26	52.36	53.46	54.56	55.66	56.76	57.86	58.96	60.06

Direct Front Flange Installation :

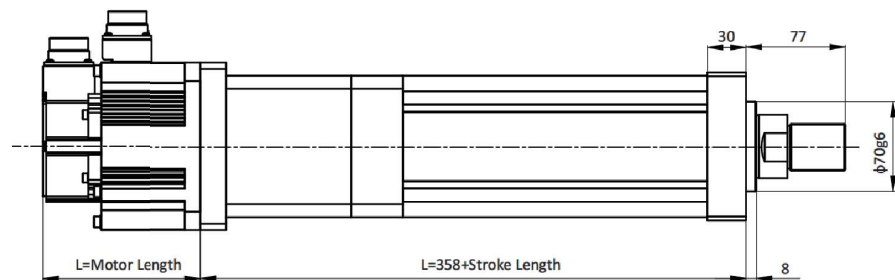
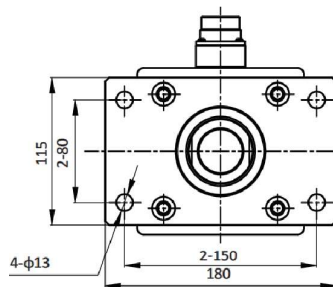

Stroke (mm)	50	100	150	200	250	300	350	400	450	500	550	600	650	700	750	800	850	900	950	1000
Weight (Kg)	15.96	17.06	18.16	19.26	20.36	21.46	22.56	23.66	24.76	25.86	26.96	28.06	29.16	30.26	31.36	32.46	33.56	34.66	35.76	36.86
Stroke (mm)	1050	1100	1150	1200	1250	1300	1350	1400	1450	1500	1550	1600	1650	1700	1750	1800	1850	1900	1950	2000
Weight (Kg)	37.96	39.06	40.16	41.26	42.36	43.46	44.56	45.66	46.76	47.86	48.96	50.06	51.16	52.26	53.36	54.46	55.56	56.66	57.76	58.86

Linear Electric Actuator

Series AVRS

Cat :

Direct Rear Flange Installation :

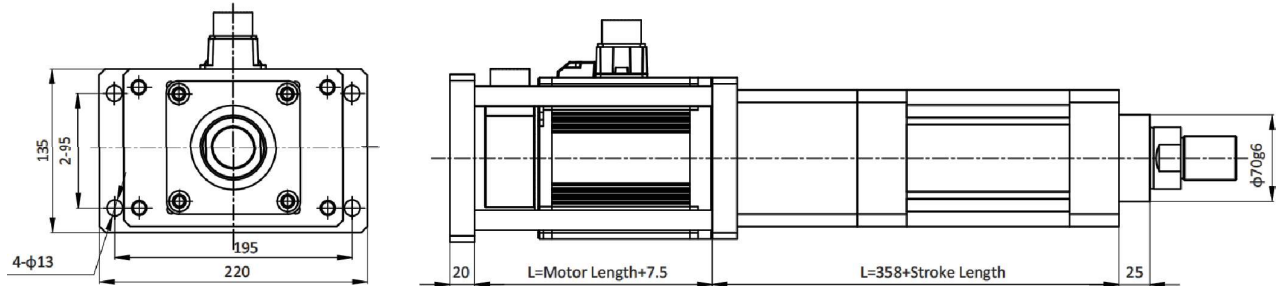

Stroke (mm)	50	100	150	200	250	300	350	400	450	500	550	600	650	700	750	800	850	900	950	1000
Weight (Kg)	19.57	20.67	21.77	22.87	23.97	25.07	26.17	27.27	28.37	29.47	30.57	31.67	32.77	33.87	34.97	36.07	37.17	38.27	39.37	40.47
Stroke (mm)	1050	1100	1150	1200	1250	1300	1350	1400	1450	1500	1550	1600	1650	1700	1750	1800	1850	1900	1950	2000
Weight (Kg)	41.57	42.67	43.77	44.87	45.97	47.07	48.17	49.27	50.37	51.47	52.57	53.67	54.77	55.87	56.97	58.07	59.17	60.27	61.37	62.47

Direct Trunnion Installation :

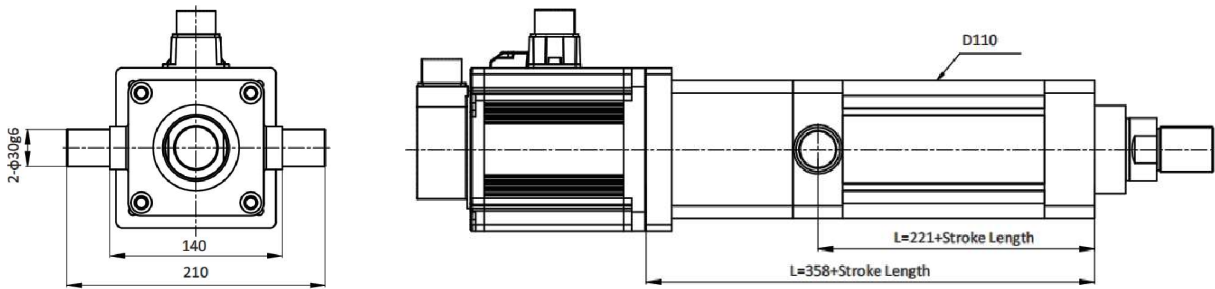

Stroke (mm)	50	100	150	200	250	300	350	400	450	500	550	600	650	700	750	800	850	900	950	1000
Weight (Kg)	16.67	17.77	18.87	19.97	21.07	22.17	23.27	24.37	25.47	26.57	27.67	28.77	29.87	30.97	32.07	33.17	34.27	35.37	36.47	37.57
Stroke (mm)	1050	1100	1150	1200	1250	1300	1350	1400	1450	1500	1550	1600	1650	1700	1750	1800	1850	1900	1950	2000
Weight (Kg)	38.67	39.77	40.87	41.97	43.07	44.17	45.27	46.37	47.47	48.57	49.67	50.77	51.87	52.97	54.07	55.17	56.27	57.37	58.47	59.57

Direct Side Installation :

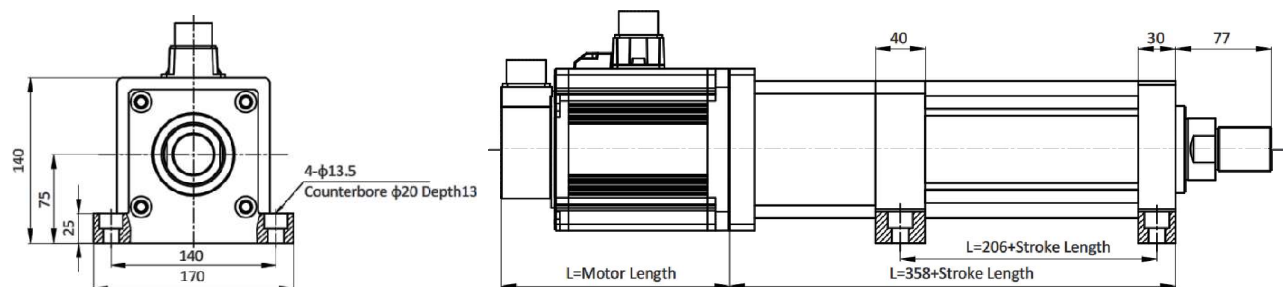

Stroke (mm)	50	100	150	200	250	300	350	400	450	500	550	600	650	700	750	800	850	900	950	1000
Weight (Kg)	16.89	17.99	19.09	20.19	21.29	22.39	23.49	24.59	25.69	26.79	27.89	28.99	30.09	31.19	32.29	33.39	34.49	35.59	36.69	37.79
Stroke (mm)	1050	1100	1150	1200	1250	1300	1350	1400	1450	1500	1550	1600	1650	1700	1750	1800	1850	1900	1950	2000
Weight (Kg)	38.89	39.99	41.09	42.19	43.29	44.39	45.49	46.59	47.69	48.79	49.89	50.99	52.09	53.19	54.29	55.39	56.49	57.59	58.69	59.79

Linear Electric Actuator

Series AVRS

Cat :

Direct Front Guide Installation :

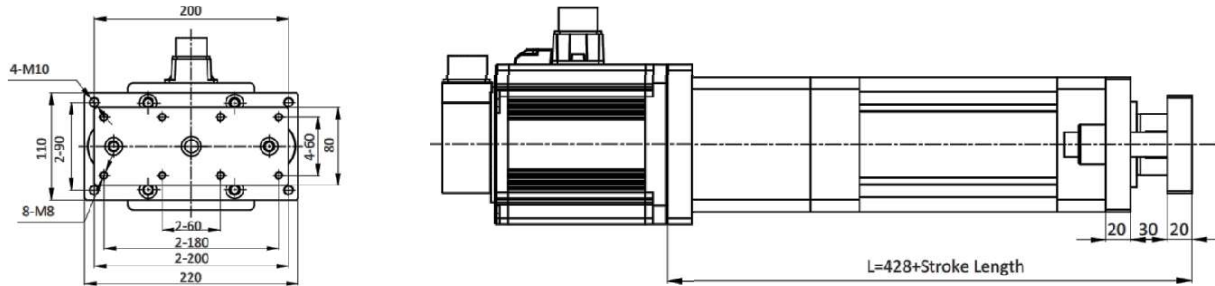

Stroke (mm)	50	100	150	200	250	300	350	400	450	500	550	600	650	700	750	800	850	900	950	1000
Weight (Kg)	16.82	18.17	19.52	20.87	22.22	23.57	24.92	26.27	27.62	28.97	30.32	31.67	33.02	34.37	35.72	37.07	38.42	39.77	41.12	42.47
Stroke (mm)	1050	1100	1150	1200	1250	1300	1350	1400	1450	1500	1550	1600	1650	1700	1750	1800	1850	1900	1950	2000
Weight (Kg)	43.82	45.17	46.52	47.87	49.22	50.57	51.92	53.27	54.62	55.97	57.32	58.67	60.02	61.37	62.72	64.07	65.42	66.77	68.12	69.47

Direct Male Clevis Installation :

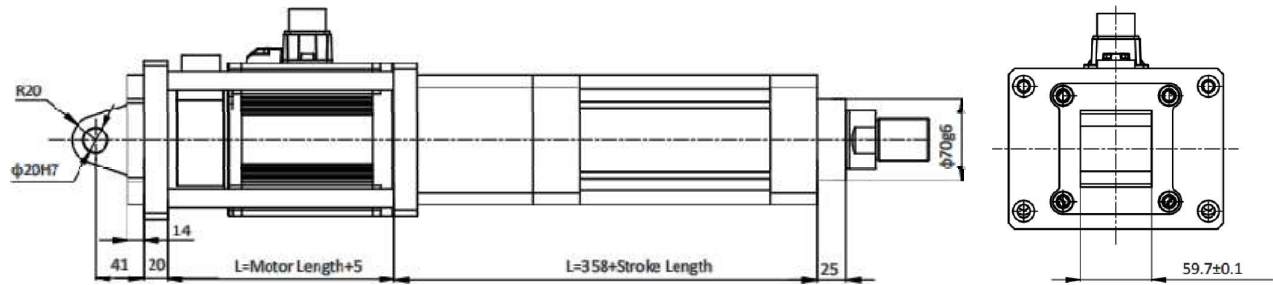

Stroke (mm)	50	100	150	200	250	300	350	400	450	500	550	600	650	700	750	800	850	900	950	1000
Weight (Kg)	20.65	21.75	22.85	23.95	25.05	26.15	27.25	28.35	29.45	30.55	31.65	32.75	33.85	34.95	36.05	37.15	38.25	39.35	40.45	41.55
Stroke (mm)	1050	1100	1150	1200	1250	1300	1350	1400	1450	1500	1550	1600	1650	1700	1750	1800	1850	1900	1950	2000
Weight (Kg)	42.65	43.75	44.85	45.95	47.05	48.15	49.25	50.35	51.45	52.55	53.65	54.75	55.85	56.95	58.05	59.15	60.25	61.35	62.45	63.55

Direct Female Clevis Installation :

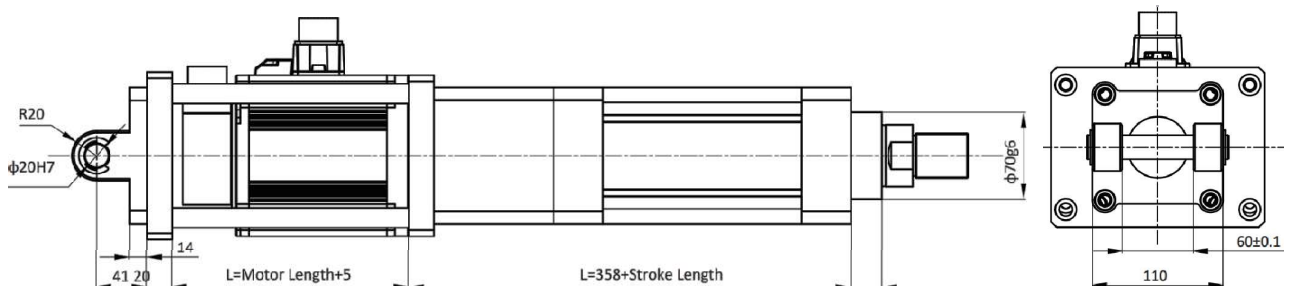

Stroke (mm)	50	100	150	200	250	300	350	400	450	500	550	600	650	700	750	800	850	900	950	1000
Weight (Kg)	20.76	21.86	22.96	24.06	25.16	26.26	27.36	28.46	29.56	30.66	31.76	32.86	33.96	35.06	36.16	37.26	38.36	39.46	40.56	41.66
Stroke (mm)	1050	1100	1150	1200	1250	1300	1350	1400	1450	1500	1550	1600	1650	1700	1750	1800	1850	1900	1950	2000
Weight (Kg)	42.76	43.86	44.96	46.06	47.16	48.26	49.36	50.46	51.56	52.66	53.76	54.86	55.96	57.06	58.16	59.26	60.36	61.46	62.56	63.66

Linear Electric Actuator

Series AVRS

Cat :

Transition Trunnion Installation :

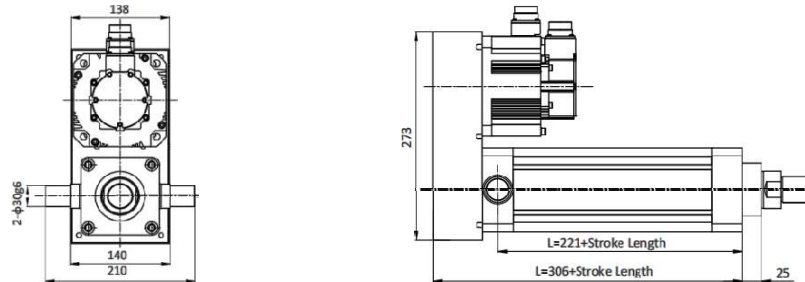

Stroke (mm)	50	100	150	200	250	300	350	400	450	500	550	600	650	700	750	800	850	900	950	1000
Weight (Kg)	15.29	16.39	17.49	18.59	19.69	20.79	21.89	22.99	24.09	25.19	26.29	27.39	28.49	29.59	30.69	31.79	32.89	33.99	35.09	36.19
Stroke (mm)	1050	1100	1150	1200	1250	1300	1350	1400	1450	1500	1550	1600	1650	1700	1750	1800	1850	1900	1950	2000
Weight (Kg)	37.29	38.39	39.49	40.59	41.69	42.79	43.89	44.99	46.09	47.19	48.29	49.39	50.49	51.59	52.69	53.79	54.89	55.99	57.09	58.19

Transition Side Installation :

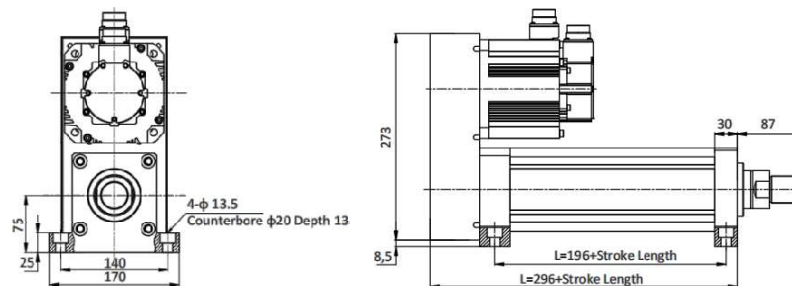

Stroke (mm)	50	100	150	200	250	300	350	400	450	500	550	600	650	700	750	800	850	900	950	1000
Weight (Kg)	15.82	16.92	18.02	19.12	20.22	21.32	22.42	23.52	24.62	25.72	26.82	27.92	29.02	30.12	31.22	32.32	33.42	34.52	35.62	36.72
Stroke (mm)	1050	1100	1150	1200	1250	1300	1350	1400	1450	1500	1550	1600	1650	1700	1750	1800	1850	1900	1950	2000
Weight (Kg)	37.82	38.92	40.02	41.12	42.22	43.32	44.42	45.52	46.62	47.72	48.82	49.92	51.02	52.12	53.22	54.32	55.42	56.52	57.62	58.72

Transition Front Guide Installation :

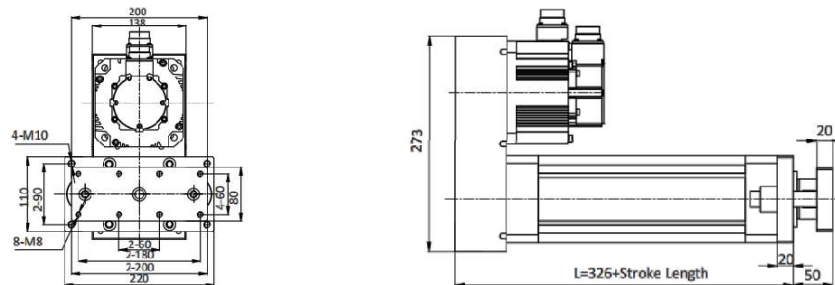

Stroke (mm)	50	100	150	200	250	300	350	400	450	500	550	600	650	700	750	800	850	900	950	1000
Weight (Kg)	15.75	17.10	18.45	19.80	21.15	22.50	23.85	25.20	26.55	27.90	29.25	30.60	31.95	33.30	34.65	36.00	37.35	38.70	40.05	41.40
Stroke (mm)	1050	1100	1150	1200	1250	1300	1350	1400	1450	1500	1550	1600	1650	1700	1750	1800	1850	1900	1950	2000
Weight (Kg)	42.75	44.10	45.45	46.80	48.15	49.50	50.85	52.20	53.55	54.90	56.25	57.60	58.95	60.30	61.65	63.00	64.35	65.70	67.05	68.40

Linear Electric Actuator

Series AVRS

Cat :

Transition Male Clevis Installation :

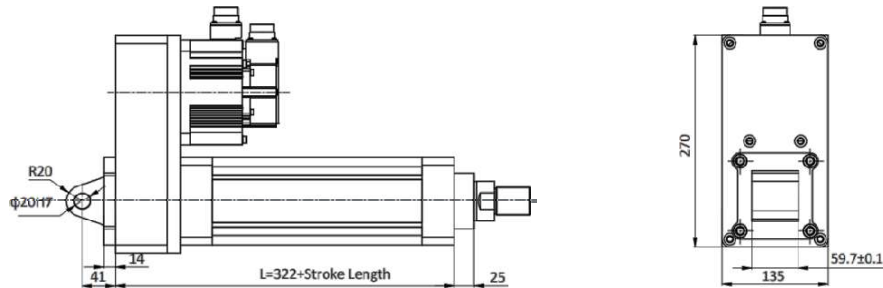

Stroke (mm)	50	100	150	200	250	300	350	400	450	500	550	600	650	700	750	800	850	900	950	1000
Weight (Kg)	24.08	25.18	26.28	27.38	28.48	29.58	30.68	31.78	32.88	33.98	35.08	36.18	37.28	38.38	39.48	40.58	41.68	42.78	43.88	44.98
Stroke (mm)	1050	1100	1150	1200	1250	1300	1350	1400	1450	1500	1550	1600	1650	1700	1750	1800	1850	1900	1950	2000
Weight (Kg)	46.08	47.18	48.28	49.38	50.48	51.58	52.68	53.78	54.88	55.98	57.08	58.18	59.28	60.38	61.48	62.58	63.68	64.78	65.88	66.98

Transition Female Clevis Installation :

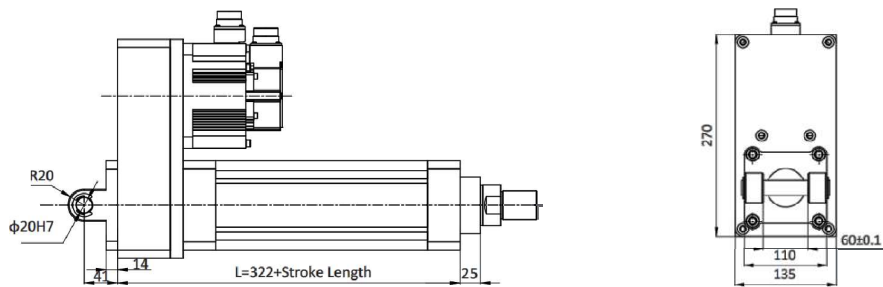

Stroke (mm)	50	100	150	200	250	300	350	400	450	500	550	600	650	700	750	800	850	900	950	1000
Weight (Kg)	24.19	25.29	26.39	27.49	28.59	29.69	30.79	31.89	32.99	34.09	35.19	36.29	37.39	38.49	39.59	40.69	41.79	42.89	43.99	45.09
Stroke (mm)	1050	1100	1150	1200	1250	1300	1350	1400	1450	1500	1550	1600	1650	1700	1750	1800	1850	1900	1950	2000
Weight (Kg)	46.19	47.29	48.39	49.49	50.59	51.69	52.79	53.89	54.99	56.09	57.19	58.29	59.39	60.49	61.59	62.69	63.79	64.89	65.99	67.09

Linear Electric Actuator

Series AVRS

Cat :

How to Order

AVRS100

Lead	
05	5mm
10	10mm

Stroke	
0050-1000mm	

Motor Position	
D	Direct
L	Left Side
R	Right Side
B	Bottom Side

Motor Make	
Servo	
D	Delta
Y	Yaskawa
M	Mitsubishi
P	Panasonic
V	INVT
T	Others

Motor Power	
Servo	
F	1KW
G	1.5KW
H	2KW
J	3KW

Brake	
	Without Brake
B	With Brake

Gear Specification	
	Without Gear Box
P02 to P50	Planetary Gear Box*

Encoder Type	
	Incremental
A	Absolute

Communication Type	
Basic Type	
C0	Modbus
C1	CAN Open
C2	Ether CAT
C3	PROFINET
C4	PROFIBUS
C5	Ethernet/IP
C6	Other Protocol -1
C7	Other Protocol -2
C8	Own Protocol -1*
C9	Own Protocol -2*

Motor & Encoder Cable	
1	1m
3	3m
5	5m
T	10m

I/O Cable	
Without Cable (Standard)	
1	1m
A	1.5m
2	2m

Piston Rod Thread Type	
Male Thread	
F	Female Thread
S	Rod end Spherical eye
R	Rod end Fork

Note :

P	Gear Reduction
S	Over Drive

Note : * Based on Motor make

Actuator Mounting Portion	
Front Installation	
1	Front Flange Installation
2	Rear Flange Installation
3	Trunnion Installation
4	Side Installation
5	Front Guide Installation
6	Male Clevis Installation
7	Female Clevis Installation

Customization Order no	
XXXX	Special Requirements

Example:1

Order no. for Rod type ball screw electric actuator VDMA 100mm size, 10mm Lead, 500mm stroke with Delta 1.5 KW servo motor mounted at the motor Direct, with 3m Motor & Encoder cable.

AVRS100100500D-DG-3N

Example:2

Order no. for Rod type ball screw electric actuator VDMA 100mm size, 10mm Lead, 500mm stroke with Delta 1.5 KW servo motor mounted at the motor Direct.

AVRS100100500D-DG